





NOTES
 SLR drawing uses topographical survey data supplied by Carter Jonas Ltd. Drawing No. PLS-306.

LEGEND

	Proposed 1.5m footway / 2m cycleway
	Proposed extension of footway
	Development site boundary

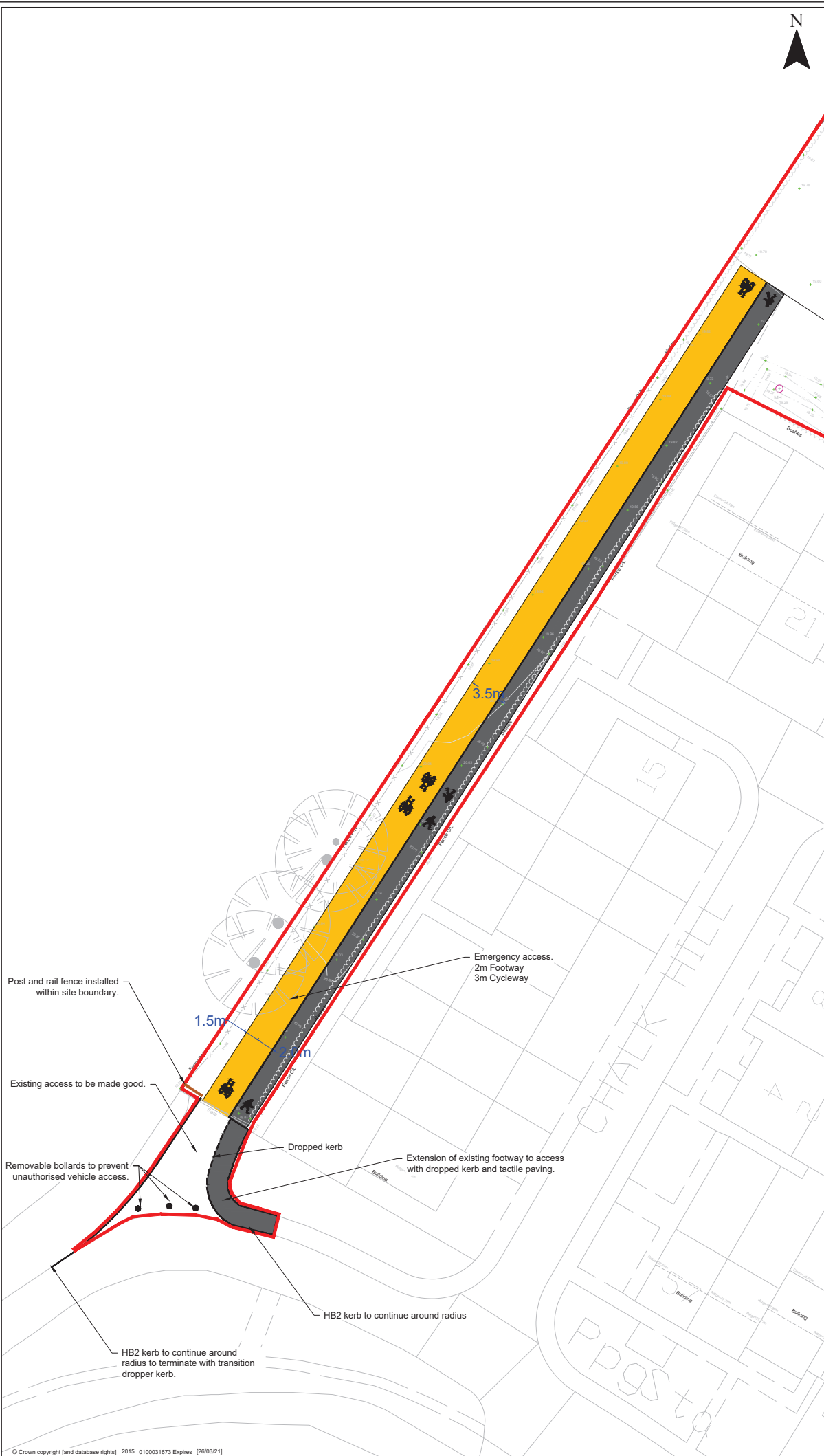

2	CB	PL	10/2020	Plan updated to reflect comments from Stage 1 RSA.
----------	----	----	---------	--



SLR
 global environmental solutions
 2ND FLOOR
 HERMES HOUSE
 HOLSWORTH PARK
 OXON BUSINESS PARK
 SHREWSBURY, SY3 0JH
 T: 01743 239250
 www.slrconsulting.com

LAND AT HAVERHILL ROAD STAPLEFORD	
TRANSPORT	
EMERGENCY ACCESS OPTION	
406.09693.00002.14.012.2	
Scale: 1:250 @ A2	Date: OCTOBER 2020

406.09693.00002.14.012.2 - Emergency Access.dwg

© Crown copyright (and database rights) 2015 0100031673 Expires [28/03/21]

© This drawing and its content are the copyright of SLR Consulting Ltd and may not be reproduced or amended except by prior written permission. SLR Consulting Ltd accepts no liability for any amendments made by other persons.