

This document should not be relied on or used in circumstances other than those for which it was prepared and for which Chris Blandford Associates was commissioned. Chris Blandford Associates accepts no responsibility for this document to any other party other than the person by whom it was commissioned.

- KEY**
- Application boundary
 - Other Land Under Applicant's Control
- Planting strategy - Open spaces**
- Existing vegetation
 - Existing trees to be retained
 - Proposed trees
 - Existing Woodland to be retained
 - Habitat retention/ translocation areas
Grasslands/Scrub mosaic + log piles
Hibernacula. Existing grassland/ scrub to be retained. For details refer to Reptile Mitigation Strategy report by ecologist.
 - Existing landscape retained
Existing natural habitat/ grassland/ scrub to be retained. For details refer to Ecologist details.
 - Retained landscape with additional grassland as required
 - Proposed Meadow
Product: Emorsgate Seeds' EM2
standard general purpose meadow mix
Supplier: Emorsgate seeds
 - Bio retention basins
Product: Flora Aqua
(70% Wildflowers and 30% Grasses)
Supplier: Tillers Turf
 - Proposed native buffer planting Type A
 - Proposed native buffer planting Type B
 - Proposed native plant mix
 - Linear Park
Proposed lawn: Lindum Festival Landscape
Turf-L17
 - Linear Park
Proposed planting
 - Proposed flowering lawn
 - Proposed aquatic / marginal planting
- Planting strategy - around built areas**
- Proposed Road verges
Product: Species Rich Lawn Turf
Product code: WFT-Species-Rich-26
Supplier: Wildflower Turf Ltd
 - Private Front Gardens
Shrubs and perennials
 - Proposed hedge
 - Proposed climbers
- Note: To see planting schedule refer to drg TRF-CBA-M2-L-4011
- Indicative location of control chamber to Engineer's details
 - Indicative location of below ground crates
 - Indicative location of headwall to Engineer's details
 - Existing Chalk Stream
 - Existing Pond

P4	28/02/20	PC	Revised Reserved Matters Application
S0	08/11/19	SM	Stage 3 Issue
P3	13/09/19	SM	Issued For Planning
P2	11/09/19	SM	Issued For Planning
P1	06/09/19	SM	Issued For Planning
PO	23/08/19	MA	Issued For Planning
Rev	Date	Drw	Revision or reason for Issue

Scale / North Point

CHRIS BLANDFORD ASSOCIATES
 landscape | environment | heritage
 The Print Rooms Studio 511 164/180 Union St Waterloo London SE1 0LH
 T +44 (0)20 7089 6480 E mail@cbastudios.com W www.cbastudios.com

Client
Castlefield International Limited

Project Title
TEVERSHAM ROAD FULBOURN

Drawing Series and Title
**4000 SERIES
 Planting Strategy - SHEET 2**

Scale @ A1
 1:500
 Drawn
 PC
 Approved
 AS
 Date
 AUG 2019
 Drawing Status
 FOR PLANNING

Drawing number
TRF-CBA-1-GF-M2-L-4001
 Revision
 P4

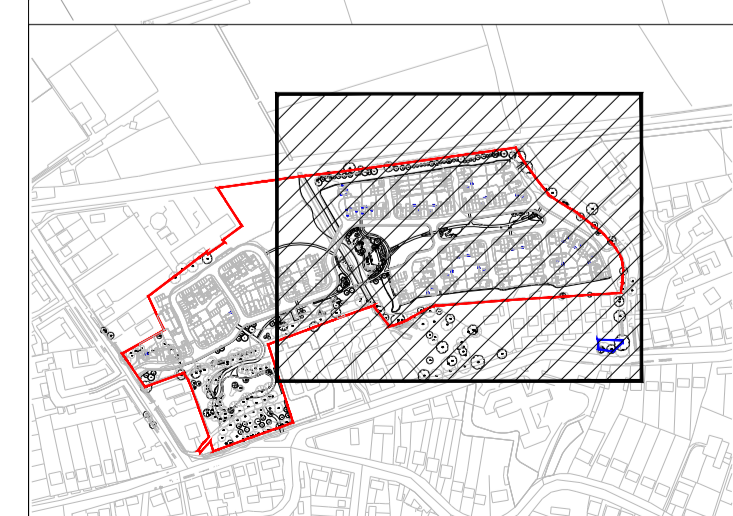

KEY PLAN

S:\projects\11129501 Teversham Road Fulbourn\4 CAD\4 Revised Reserved Matters Application\TRF-CBA-1-GF-M2-L-4001.dwg