

**NOTES**

TO BE READ IN COLOUR  
 DO NOT SCALE FROM THIS DRAWING  
 Contractors, sub-contractors and suppliers are to verify any critical dimensions on site prior to commencing work, fabrication or construction of any elements. Any discrepancies or errors must be brought to the attention of Robert Myers Associates.  
 All structural elements are shown indicatively. For all elements of structure, refer to structural engineers' and specialist sub-contractor/fabricators' design, detail and specification.  
 The drawings are to be read in conjunction with all relevant landscape architect, consultant and specialist drawings.  
 This drawing is to be read specifically in conjunction with:  
 630\_01(MP)011 Levels and Drainage (West);  
 630\_01(MP)012 Levels and Drainage (East); and  
 630\_01(MP)014 Attenuation Strategy.

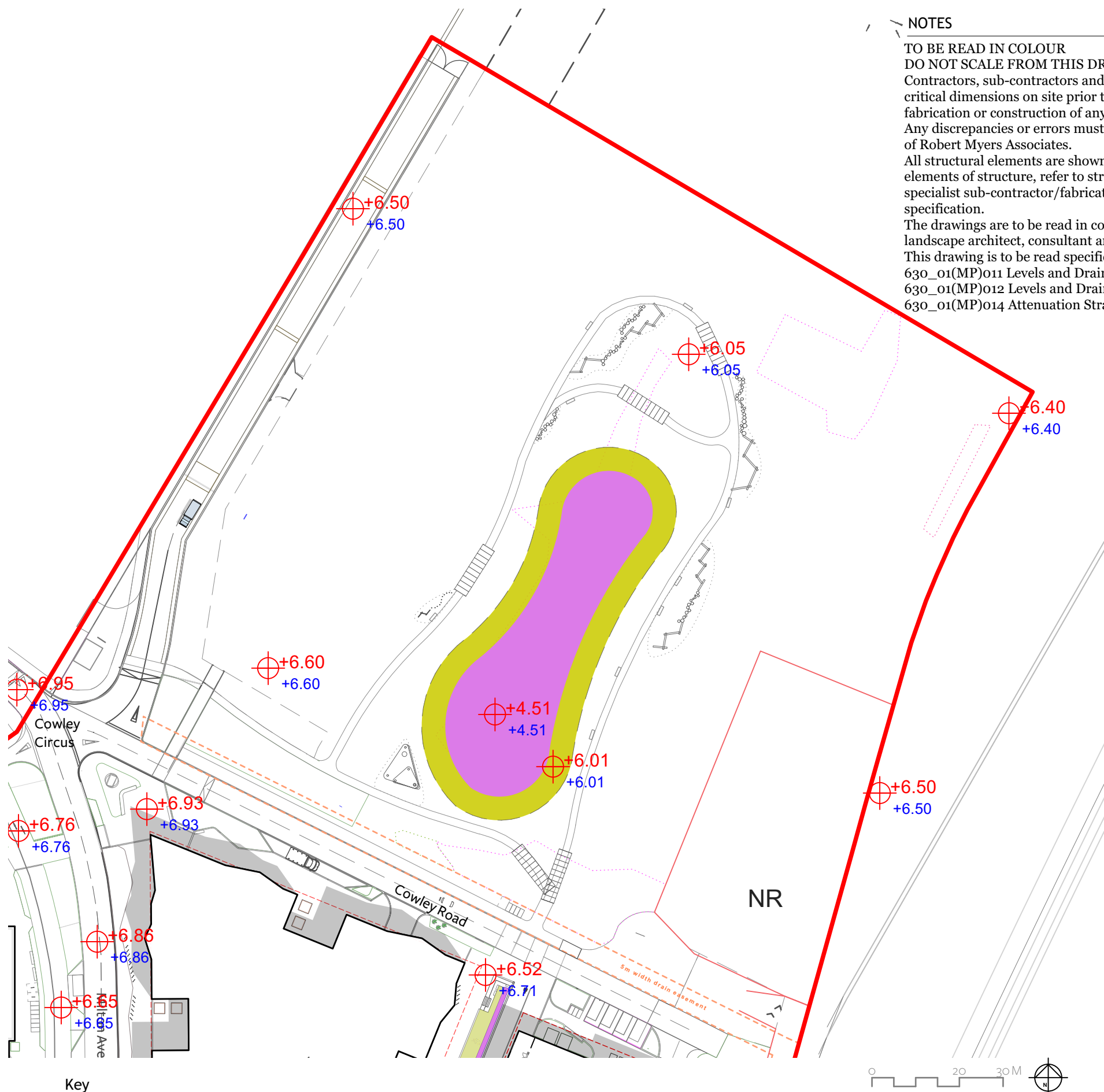

**Key**

- Site boundary
- + 0.00 Existing level  
Some very close adjacent levels have been omitted for legibility
- ⊕ 0.00 Proposed level
- Linear swale SUDs feature with permanent water at base
- Balancing pond with permanent water. Total depth 1500mm with banks at 1:3 gradient slopes
- - - Existing 'First Drain' easement 5m easement

**PURPOSE OF ISSUE**

| Rev: | Date:    | Drawing Status: |
|------|----------|-----------------|
| P1   | 01.06.22 | FOR PLANNING    |

**REVISIONS**

| Rev: | Date:    | Description: |
|------|----------|--------------|
| P1   | 01.06.22 | First Issue  |

**LOCATION PLAN SCALE: NTS**

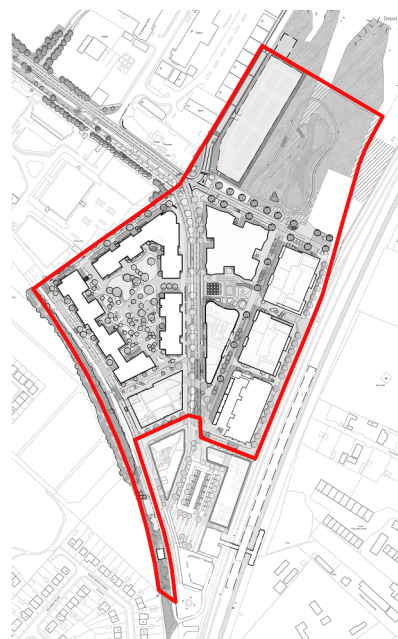

**CAMBRIDGE NORTH**

Client: Brookgate  
 Drawing: Levels and Drainage (Wild Park)  
 Project No: 630\_01  
 Drawing No: 630\_01(MP)013  
 Scale: 1:1000 @ A3      Rev: P1  
 Date: May 2022      Drawn: EL  
 Checked: JB      PM Checked: RM

**Robert Myers Associates**  
 LANDSCAPE ARCHITECTURE

13-15 Covent Garden  
 Cambridge  
 CB1 2HS      Tel: +44 (0) 1223 351400

info@robertmyers-associates.co.uk  
 www.robertmyers-associates.co.uk

DO NOT SCALE FROM THIS DRAWING  
 © Robert Myers Associates