

# Logistics Plan Northstowe Community Centre

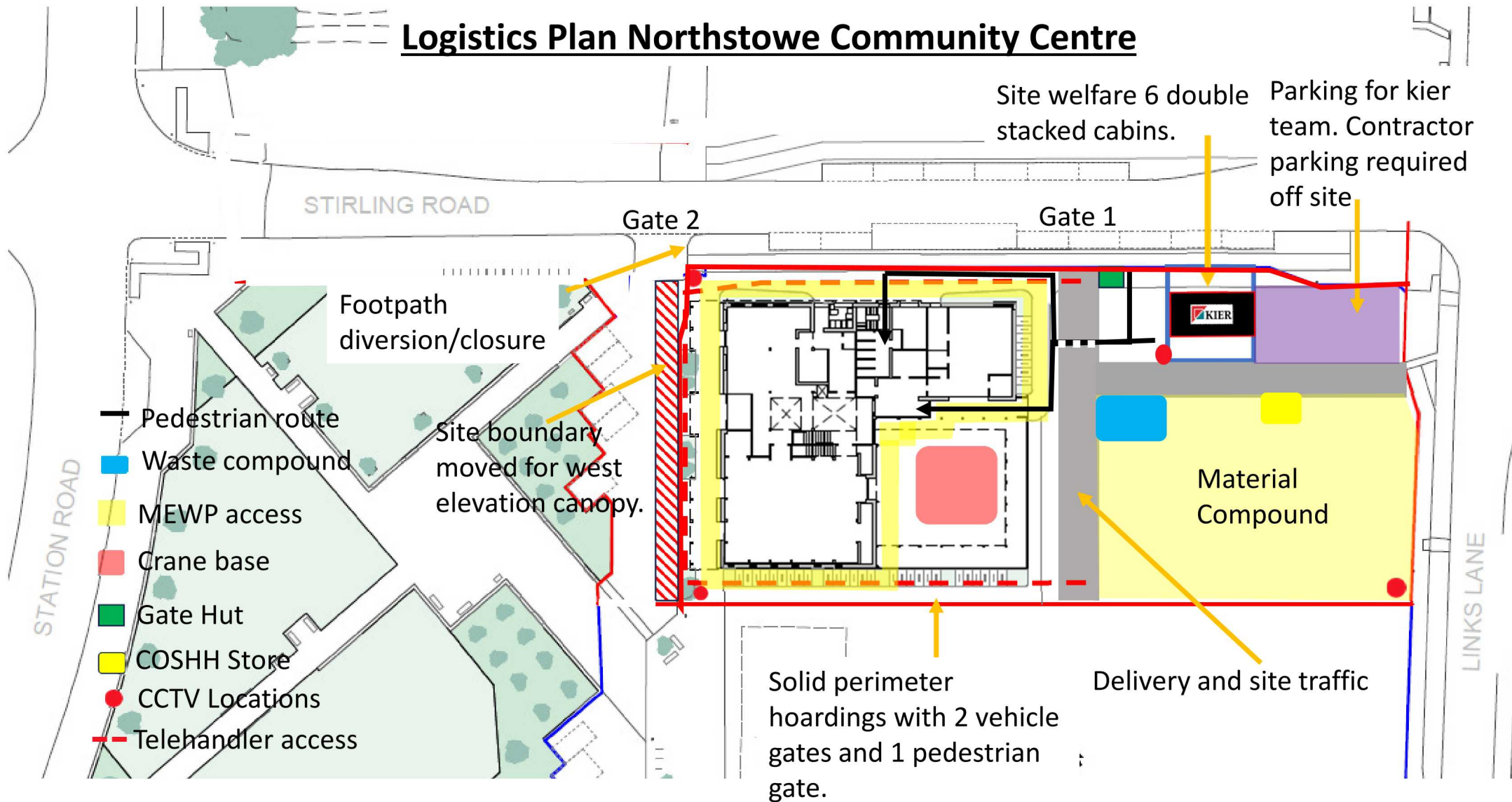

- Pedestrian route
- Waste compound
- MEWP access
- Crane base
- Gate Hut
- COSHH Store
- CCTV Locations
- - - Telehandler access

Site welfare 6 double stacked cabins.

Parking for kier team. Contractor parking required off site

STIRLING ROAD

Gate 2

Gate 1

Footpath diversion/closure

Site boundary moved for west elevation canopy.

Material Compound

Solid perimeter hoardings with 2 vehicle gates and 1 pedestrian gate.

Delivery and site traffic

STATION ROAD

LINKS LANE

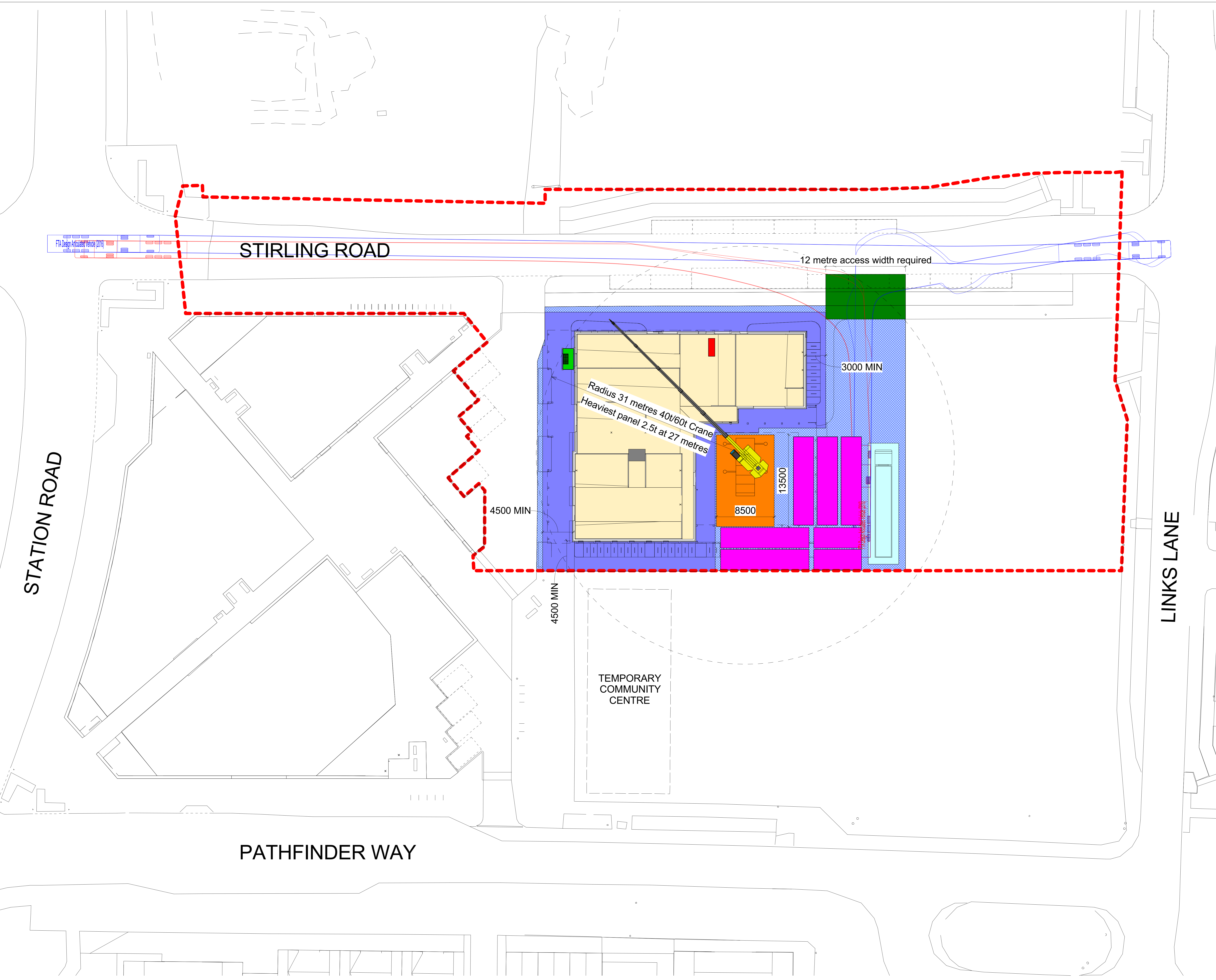

**KEY LEGEND - SITE LOGISTICS PLAN**

- SITE BOUNDARY
- MOBILE CRANE BASE
- INTEGRATED AREA
- SCAFFOLD ZONE
- MEWP ZONE
- SITE ENTRANCE
- LAYDOWN AREA
- ← LORRY IN
- LORRY OUT

**Notes**

- Eurban preference is for scaffold rather than MEWP.
- If MEWP access is specified then please provide adequate space between building edge and hoarding, concern over the temporary hoarding supports clashing with MEWP access. Uneven ground, upstands and edge protection requirement for sloping roofs/flat.
- Suggest the following options for access to areas above the canopy level roof at the rear, boom type MEWP, potential for MEWP to move on top of low level roof or temporary ground to slope over upstands to provide MEWP access.

**Revision Schedule**

Rev	Date	Description
P01	03/06/2024	S3-REVIEW AND COMMENT
P02	07/08/2024	S3-REVIEW AND COMMENT

**EURBAN**

EURBAN Limited  
 3rd Floor T +44 (0)20 7378 8476  
 59 Lafone Street E info@eurban.co.uk  
 London SE1 2LX www.eurban.co.uk

DRAWING TITLE  
**SL-Site Logistic Plan**  
 Site Logistics

STATUS PURPOSE OF ISSUE  
**S3 REVIEW AND COMMENT**

DRAWING NO. REVISION  
**NCC-EUR-ZZ-D-S-1700 P02**

JOB TITLE  
**Northstowe Community Centre**  
 Stirling road, Northstowe, Cambridge CB24 3DR

JOB NO. CLIENT  
**4337 South Cambridgeshire Council**  
 MAIN CONTRACTOR  
**Kier**

SCALE @ A1 1/250	DATE 07/08/2024	DRAWN AR	CHECKED PKA
---------------------	--------------------	-------------	----------------

© COPYRIGHT  
 THE COPYRIGHT IN THIS DRAWING IS VESTED IN EURBAN LIMITED AND NO LICENCE OR ASSIGNMENT OF ANY KIND HAS BEEN, OR IS, GRANTED TO ANY THIRD PARTY WHETHER BY PROVISION OF COPIES OR ORIGINALS OF THE DRAWINGS OR OTHERWISE UNLESS OTHERWISE AGREED IN WRITING

FOR ELECTRONIC DATA ISSUE  
 ELECTRONIC DATA/ DRAWINGS ARE ISSUED AS "READ ONLY" AND SHOULD NOT BE INTERROGATED FOR MEASUREMENT. ALL DIMENSION AND LEVELS SHOULD BE READ, ONLY FROM THOSE VALUES STATED IN TEXT, ON THE DRAWING.

# NAME YOUR COMMUNITY CENTRE



As the construction of Northstowe Phase 1 community centre is about to begin we are asking for your help naming the building.

We have provided a few suggestions to get you started, which came out of the earlier engagement sessions for naming The Green. These names comply with South Cambridgeshire District Council's Street Naming and Numbering Policy and reflect the history of the site.

We are also giving you the opportunity to make alternative suggestions.

We are looking for a name that is distinctive to this first phase of Northstowe, but will stand the test of time, long after the builders have moved on. Names that include "town" or "central" for example will not be considered, as these would be more appropriate for future town centre (Phase 2) buildings.

The name should also be short! The design for the building includes an entrance awning with limited space for the building name.

Scan the QR code or complete a postcard in The Cabin to select your preferred name.



If you have a preference on the options we have suggested please tick the box below

## NAME

Chipping

Stirling

Fairway

New Hatton

## STYLE

House

Building

Centre

Please make any other suggestions and provide the reasoning for why you feel this would be an appropriate option. If you wish to suggest an alternative, please do so here.

*Maximum 18 characters including spaces*

Reason for alternative

Name:

Postcode:

Northstowe Resident? Yes  No

# NAME YOUR COMMUNITY CENTRE

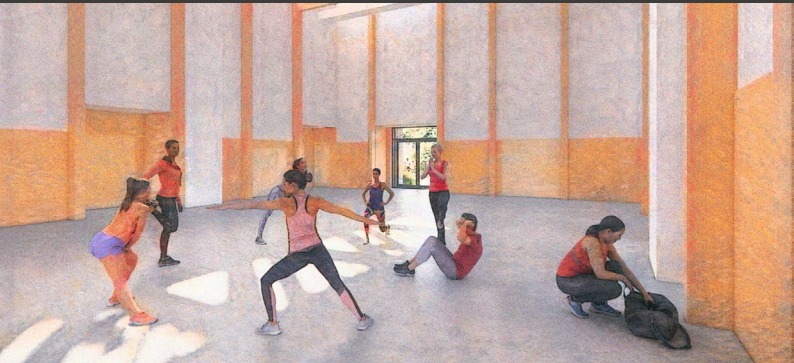

Scan the QR code or complete a postcard in The Cabin to select your preferred name.

