

Waterbeach busway

Paul van de Bulk

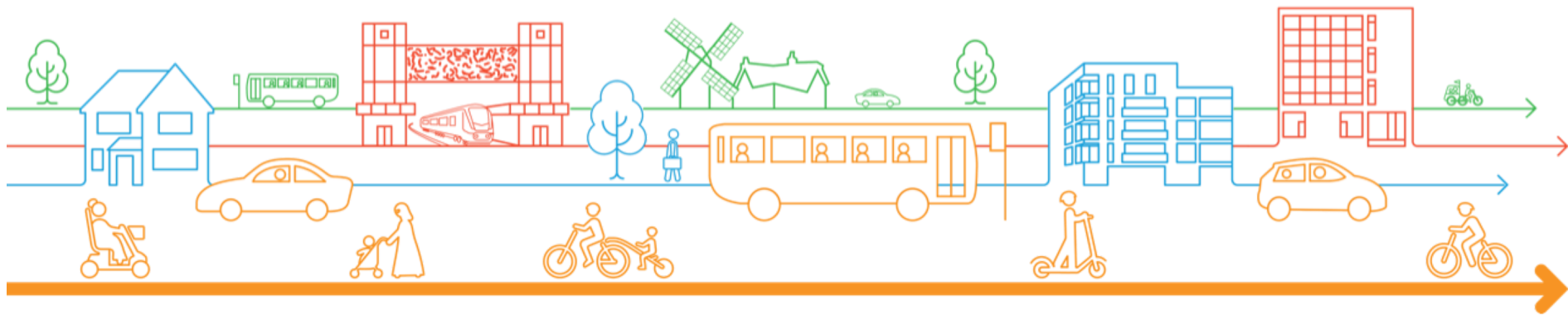

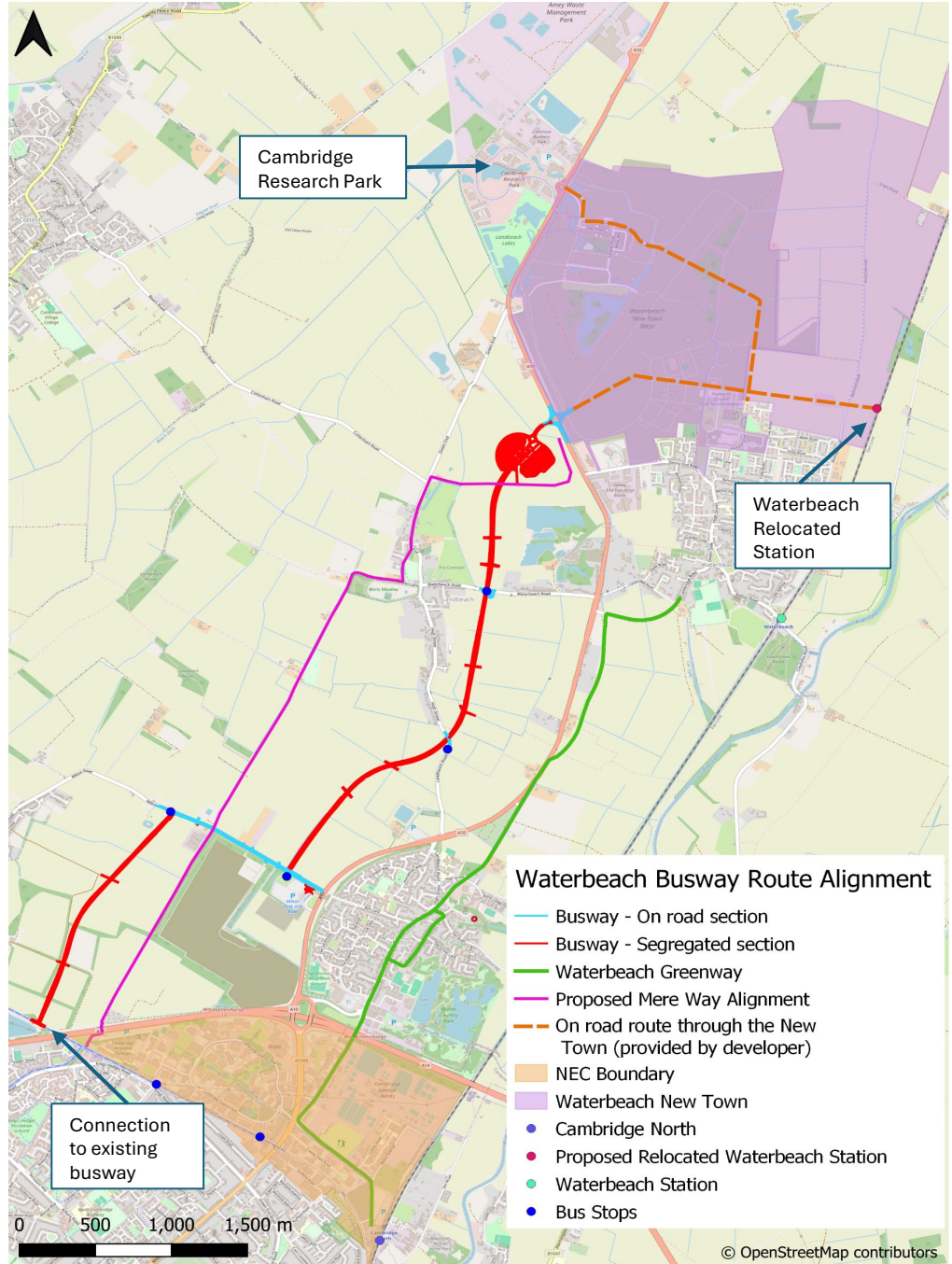

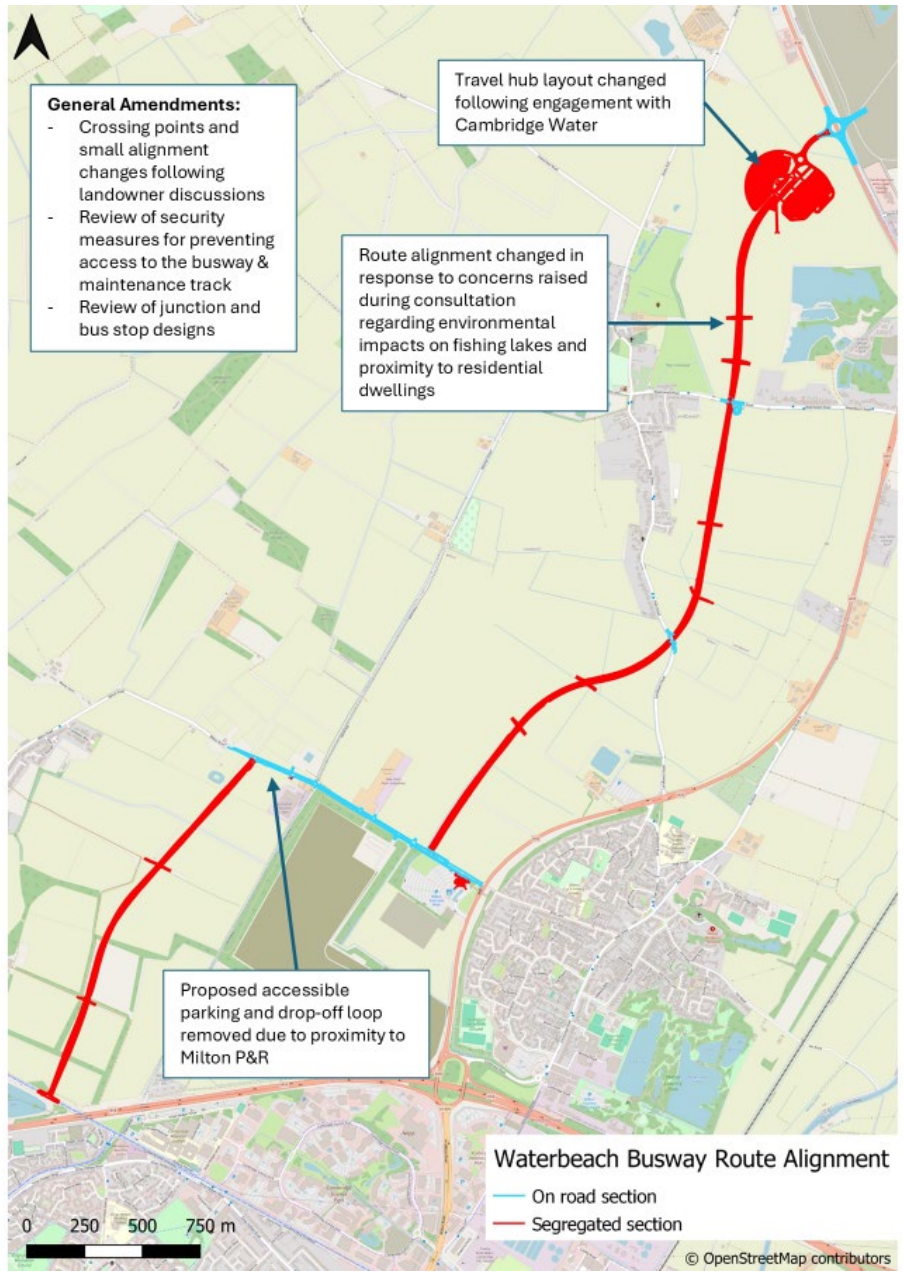

DO NOT SCALE

0 5 10
Miles
0 5 10
Kilometres

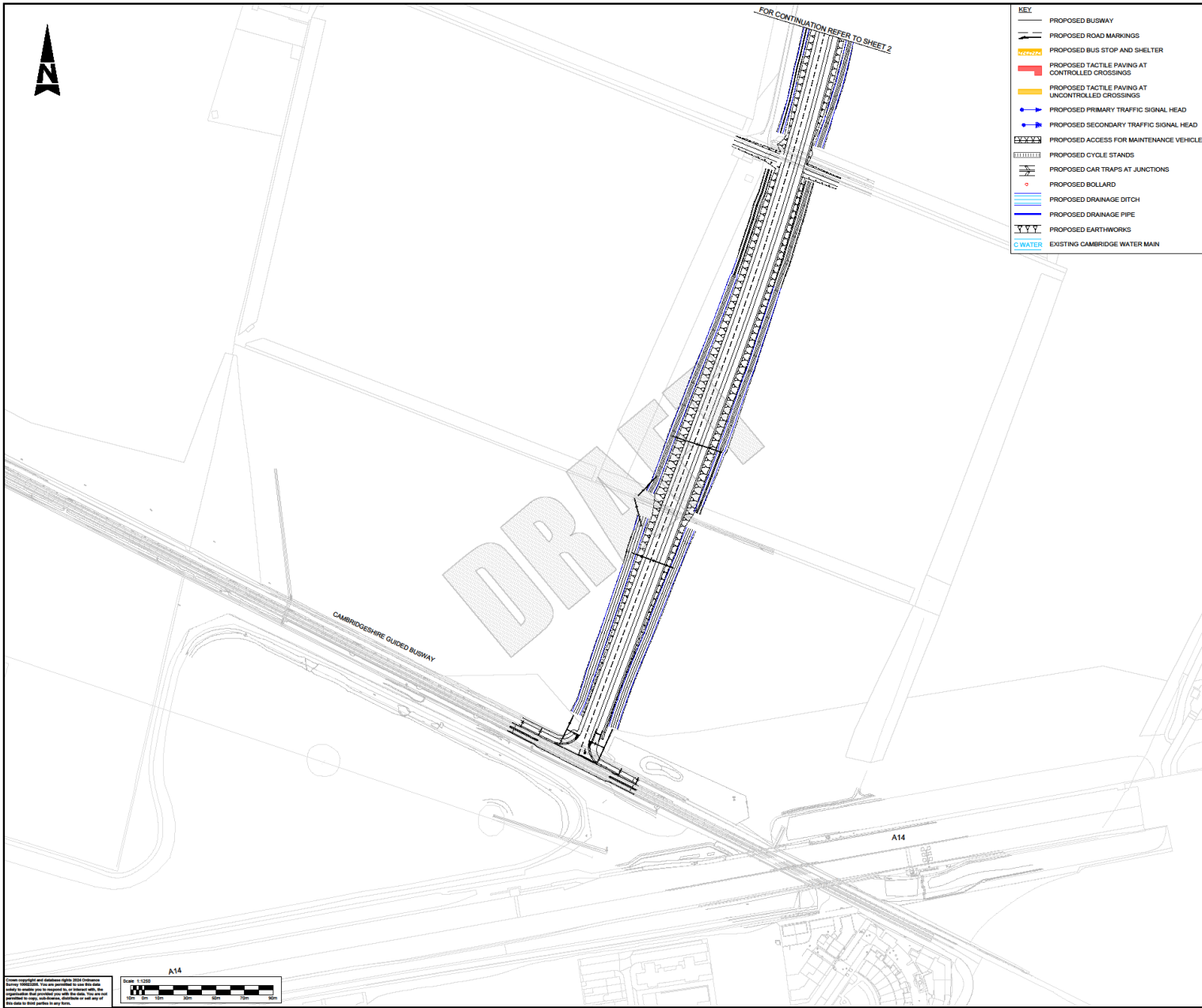

KEY	
[Symbol]	PROPOSED BUSWAY
[Symbol]	PROPOSED ROAD MARKINGS
[Symbol]	PROPOSED BUS STOP AND SHELTER
[Symbol]	PROPOSED TACTILE PAVING AT CONTROLLED CROSSINGS
[Symbol]	PROPOSED TACTILE PAVING AT UNCONTROLLED CROSSINGS
[Symbol]	PROPOSED PRIMARY TRAFFIC SIGNAL HEAD
[Symbol]	PROPOSED SECONDARY TRAFFIC SIGNAL HEAD
[Symbol]	PROPOSED ACCESS FOR MAINTENANCE VEHICLES
[Symbol]	PROPOSED CYCLE STANDS
[Symbol]	PROPOSED CAR TRAPS AT JUNCTIONS
[Symbol]	PROPOSED BOLLARD
[Symbol]	PROPOSED DRAINAGE DITCH
[Symbol]	PROPOSED DRAINAGE PIPE
[Symbol]	PROPOSED EARTHWORKS
[Symbol]	EXISTING CAMBRIDGE WATER MAIN

- NOTES**
1. ALL DIMENSIONS ARE IN METRES UNLESS STATED OTHERWISE
 2. THIS DRAWING IS TO BE PRINTED IN COLOUR.
 3. SOME ITEMS DESCRIBED IN THE NOTES AND KEY MAY NOT APPLY TO THIS DRAWING.
 4. THE INFORMATION SHOWN ON THIS DRAWING IS INDICATIVE AND SUBJECT TO CHANGE PENDING FURTHER DESIGN DEVELOPMENT.
 5. THIS DRAWING HAS BEEN PREPARED BASED ON THE AERIAL TOPOGRAPHICAL SURVEY PROVIDED JUNE 2023 AND IS TO BE VALIDATED AGAINST THE GROUND TOPOGRAPHICAL SURVEY ONCE AVAILABLE.
 6. ENVIRONMENTAL MITIGATIONS NOT FINALISED AND THEREFORE NOT SHOWN.
 7. LIGHTING IS PROPOSED AT JUNCTIONS, TRAVEL HUB AND SENSITIVE LOCATIONS. LIGHTING DESIGN NOT FINALISED AND THEREFORE NOT SHOWN.
 8. DRAINAGE DESIGN INCOMPLETE. DITCHES TO BE FINALISED AND EXTENDED WHERE REQUIRED. HEADWALLS AND OUTFALLS TO BE DESIGNED.
 9. EXISTING UTILITIES PRESENT BUT NOT SHOWN EXCEPT THE CAMBRIDGE WATER MAIN. UTILITIES DIVERSIONS TO BE DESIGNED ONCE CSS ARE COMPLETED.
 10. TRAVEL HUB LAYOUT IS INDICATIVE AND SUBJECT TO CHANGE
 11. UTILITIES AND INFRASTRUCTURE ON THE TRAVEL HUB, INCLUDING LIGHTING, SOLAR PANEL CANOPIES, BUILDING INFRASTRUCTURE, CONNECTIONS AND POWER SUPPLY, NOT DESIGNED AND NOT SHOWN.
 12. FLOOD COMPENSATION AREAS BEING DEVELOPED AND NOT SHOWN UNTIL VALIDATION WITH THE ENVIRONMENT AGENCY.

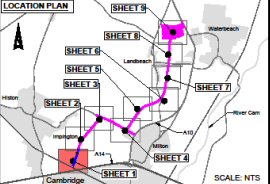

Description	Status	Revision	Drawn	Checked	Reviewed	Authorised	Issue Date

 5 Wellbrook Court
 Gilton Road
 Cambridge
 Cambridgeshire
 CB3 0NA
 Tel: +44 (0)1223 270002
 Fax: +44 (0)1223 277029
 www.atkinsrealis.com

 GREATER CAMBRIDGE PARTNERSHIP
 Growing and sharing prosperity
 Collaborating our City and County

PROJECT TITLE
 WATERBEACH TO CAMBRIDGE PUBLIC TRANSPORT SCHEME
Drawing Title
 PROPOSED GENERAL ARRANGEMENT SHEET 1 OF 9

Drawing Number W2CPTS - ATK - HGN - XX Title DR - CH - 002001	Originator HGN Author CH	Revision 1 of 9 Issue P01.2
---	---	--

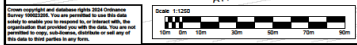

DC NOT SCALE

Metres

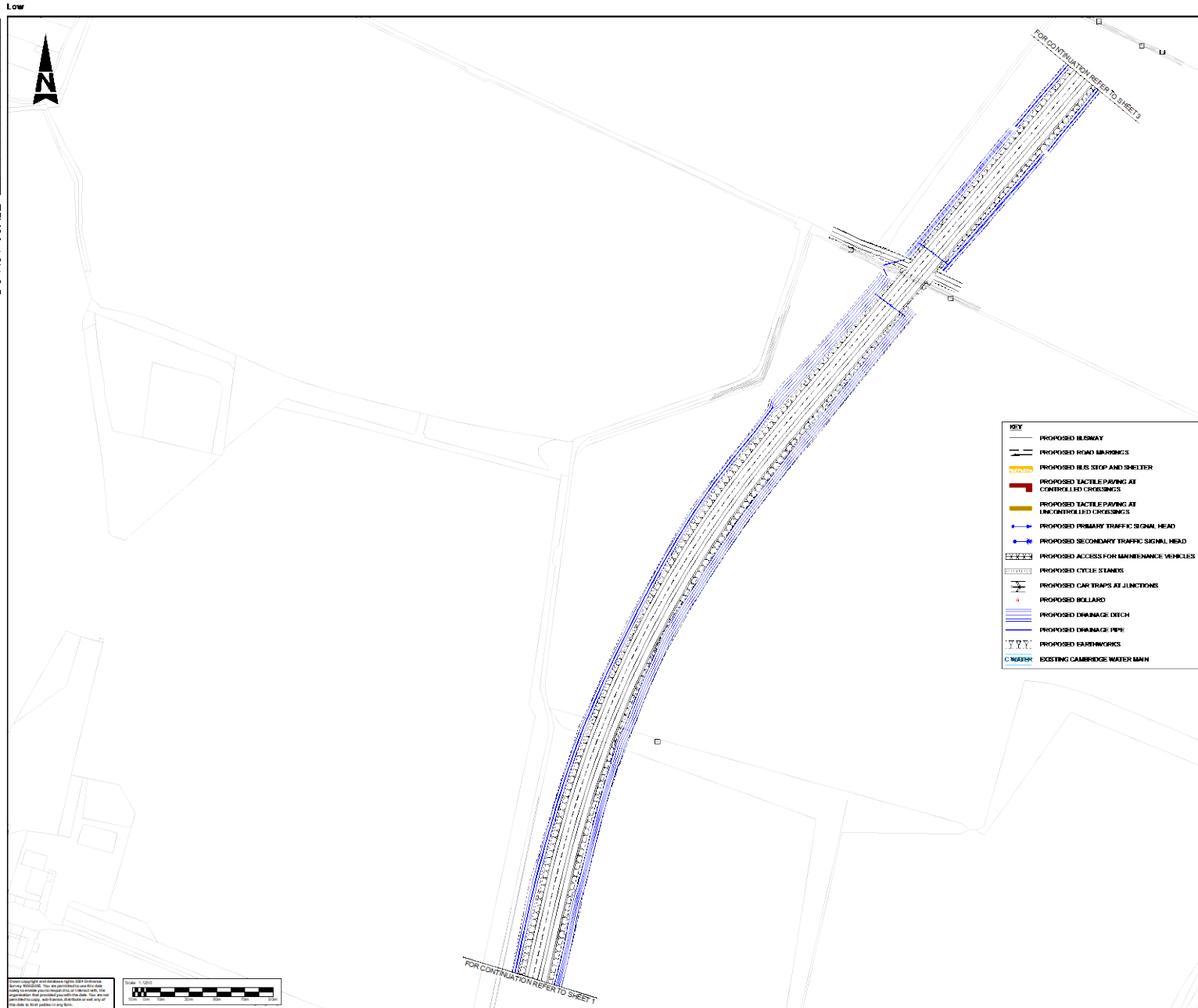

KEY	
	PROPOSED BUSWAY
	PROPOSED ROAD MARKINGS
	PROPOSED BUS STOP AND SHELTER
	PROPOSED TACTILE PAVING AT CONTROLLED CROSSINGS
	PROPOSED TACTILE PAVING AT UNCONTROLLED CROSSINGS
	PROPOSED PRIMARY TRAFFIC SIGNAL HEAD
	PROPOSED SECONDARY TRAFFIC SIGNAL HEAD
	PROPOSED ACCESS FOR MAINTENANCE VEHICLES
	PROPOSED CYCLE STANES
	PROPOSED CAR TRAPS AT JUNCTIONS
	PROPOSED BOLLARD
	PROPOSED DRAINAGE DITCH
	PROPOSED DRAINAGE PIPE
	PROPOSED PAVEMENTWORKS
	EXISTING CAMBRIDGE WATER MAIN

- NOTES**
1. ALL DIMENSIONS ARE IN METRES UNLESS STATED OTHERWISE.
 2. THIS DRAWING IS TO BE PRINTED IN COLOUR.
 3. SOME ITEMS DESCRIBED IN THE NOTES AND KEY MAY NOT APPLY TO THIS DRAWING.
 4. THE INFORMATION SHOWN ON THIS DRAWING IS INDICATIVE AND IS SUBJECT TO CHANGE PENDING FURTHER DESIGN DEVELOPMENT.
 5. THIS DRAWING HAS BEEN PREPARED BASED ON THE AERIAL TOPOGRAPHICAL SURVEY PROVIDED. ARE ZONES ARE TO BE VALIDATED AGAINST THE GROUND TOPOGRAPHICAL SURVEY ONCE AVAILABLE.
 6. ENVIRONMENTAL MITIGATIONS NOT FINALISED AND THEREFORE NOT SHOWN.
 7. LIGHTING IS PROPOSED AT JUNCTIONS, TRAVEL HUBS AND SENSITIVE LOCATIONS. LIGHTING DESIGN NOT FINALISED AND THEREFORE NOT SHOWN.
 8. DRAINAGE DESIGN INCOMPLETE. DITCHES TO BE FINALISED AND EXTENDED WHERE REQUIRED. HEADWALLS AND GUTTERALS TO BE DESIGNED.
 9. EXISTING UTILITIES PRESENT BUT NOT SHOWN EXCEPT THE CAMBRIDGE WATER MAIN. UTILITIES DIVISIONS TO BE DESIGNED ONCE CDS ARE COMPLETED.
 10. TRAVEL HUB LAYOUT IS INDICATIVE AND SUBJECT TO CHANGE.
 11. UTILITIES AND INFRASTRUCTURE ON THE TRAVEL HUB, INCLUDING LIGHTING, SOLAR PANEL CANOPIES, BUILDING INFRASTRUCTURE, CONNECTIONS AND POWER SUPPLY, NOT DESIGNED AND NOT SHOWN.
 12. FLOOD COMPENSATION AREAS BEING DEVELOPED AND NOT SHOWN UNTIL VALIDATION WITH THE ENVIRONMENT AGENCY.

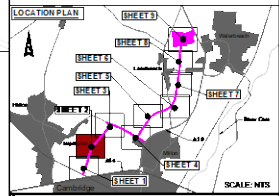

Description						
Issue	Author	Owner	Checked	Reviewed	Authorised	Issue Date
Description						
Description						
Description						
Description						

AtkinsRéalis

15 Malvern Court
Golf Course Road
Cambridge
Cambridgeshire
CB3 9NA
Tel: +44 (0)1223 276000
Fax: +44 (0)1223 276200
www.atkinsrealis.com

Copyright © AtkinsRéalis (2024)

GREATER CAMBRIDGE PARTNERSHIP

Growing and sharing prosperity
for everyone in the East

Project Title
WATERBEACH TO CAMBRIDGE
PUBLIC TRANSPORT SCHEME

Drawing Title
PROPOSED GENERAL ARRANGEMENT
SHEET 2 OF 9

Drawing Number		Project		Drawing Title	
WZCPTS	XX	ATK	HGM	DR - CH	002002
Sheet	A1	Issue	1-000	Project Ref	6228204
Scale	1:1000	Issue	2 of 9	Sheet	PD 12

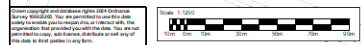

This Drawing is based on Project/Drawings: P044-E 04/02/2024 09/08/08 by: CRO3/R02

DO NOT SCALE

Metres

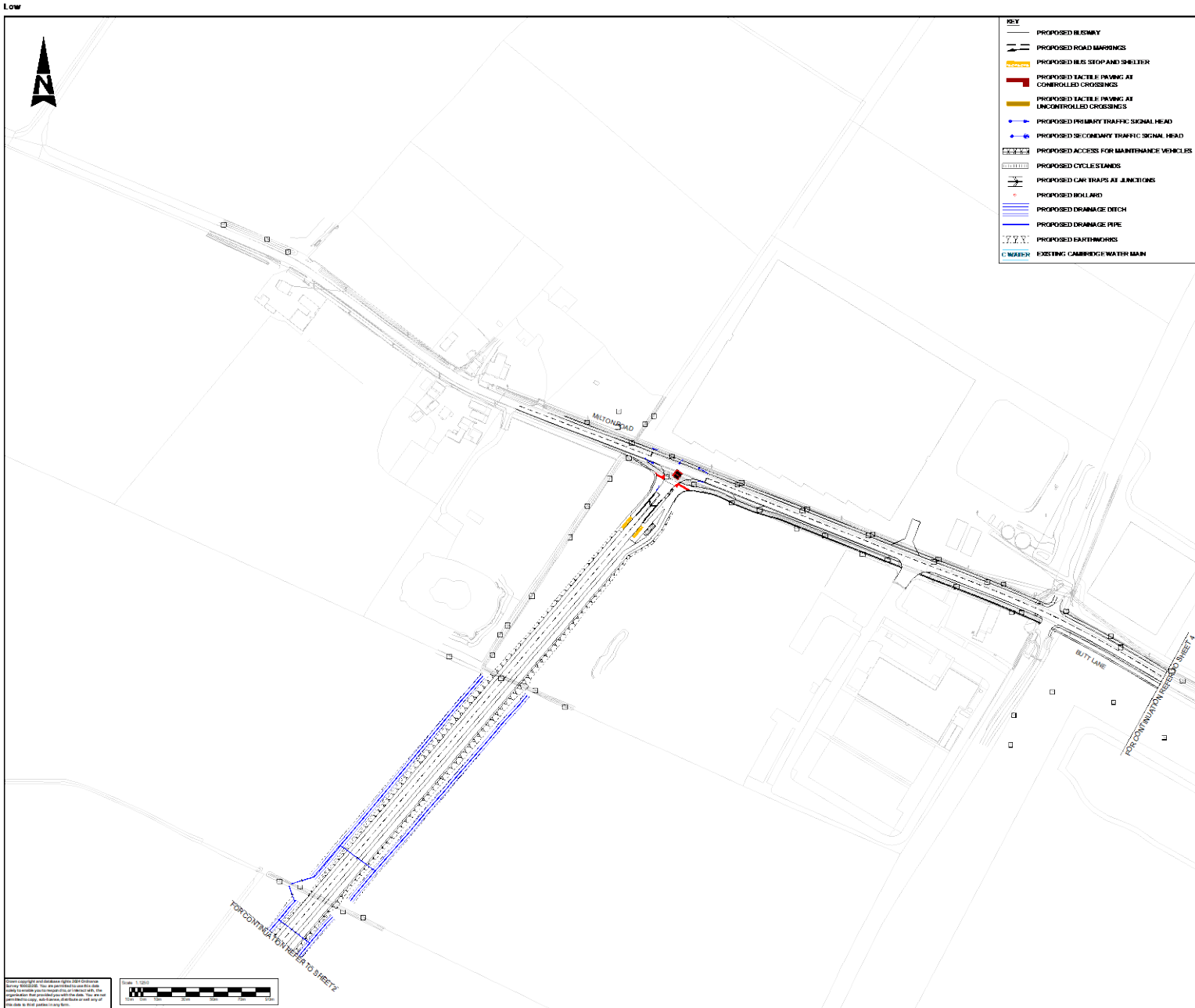

- KEY**
- PROPOSED BUSWAY
 - PROPOSED ROAD MARKINGS
 - PROPOSED BUS STOP AND SHELTER
 - PROPOSED TACTILE PAVING AT CONTROLLED CROSSINGS
 - PROPOSED TACTILE PAVING AT UNCONTROLLED CROSSINGS
 - PROPOSED PRIMARY TRAFFIC SIGNAL HEAD
 - PROPOSED SECONDARY TRAFFIC SIGNAL HEAD
 - PROPOSED ACCESS FOR MAINTENANCE VEHICLES
 - PROPOSED CYCLE STANDS
 - PROPOSED CAR TRAPS AT JUNCTIONS
 - PROPOSED BOLLARD
 - PROPOSED DRAINAGE DITCH
 - PROPOSED DRAINAGE PIPE
 - PROPOSED EARTHWORKS
 - EXISTING CAMBRIDGE WATER MAIN

- NOTE 3**
1. ALL DIMENSIONS ARE IN METRES UNLESS STATED OTHERWISE
 2. THIS DRAWING IS TO BE PRINTED IN COLOUR.
 3. SOME ITEMS DESCRIBED IN THE NOTES AND KEY MAY NOT APPLY TO THIS DRAWING.
 4. THE INFORMATION SHOWN ON THIS DRAWING IS INDICATIVE AND IS SUBJECT TO CHANGE PENDING FURTHER DESIGN DEVELOPMENT.
 5. THIS DRAWING HAS BEEN PREPARED BASED ON THE AERIAL TOPOGRAPHICAL SURVEY PROVIDED. AREAS ARE TO BE VALIDATED AGAINST THE GROUND TOPOGRAPHICAL SURVEY ONCE AVAILABLE.
 6. ENVIRONMENTAL MITIGATIONS NOT FINALISED AND THEREFORE NOT SHOWN.
 7. LIGHTING IS PROPOSED AT JUNCTIONS, TRAVEL HUBS AND SENSITIVE LOCATIONS. LIGHTING DESIGN NOT FINALISED AND THEREFORE NOT SHOWN.
 8. DRAINAGE DESIGN INCOMPLETE. DITCHES TO BE FINALISED AND EXTENDED WHERE REQUIRED. HEADWALLS AND OUTFALLS TO BE DESIGNED.
 9. EXISTING UTILITIES PRESERVE BUT NOT SHOWN EXCEPT THE CAMBRIDGE WATER MAIN. UTILITIES DIMENSIONS TO BE DESIGNED ONCE CSS ARE COMPLETED.
 10. TRAVEL HUB LAYOUT IS INDICATIVE AND SUBJECT TO CHANGE.
 11. UTILITIES AND INFRASTRUCTURE ON THE TRAVEL HUB, INCLUDING LIGHTING, SOLAR PANEL CANOPIES, BUILDING INFRASTRUCTURE, CONNECTIONS AND POWER SUPPLY, NOT DESIGNED AND NOT SHOWN.
 12. FLOOD COMPENSATION AREAS BEING DEVELOPED AND NOT SHOWN UNTIL VALIDATION WITH THE ENVIRONMENT AGENCY.

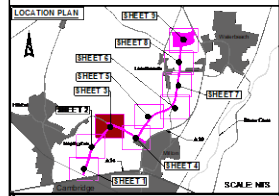

Discipline	Author	Checker	Reviewed	Approved	Issue Date
Concept					
Design					
Construction					
Operational					
As-Built					

Design Schedule

Discipline	Author	Checker	Reviewed	Approved	Issue Date
Design	PK1.2				

AtkinsRéalis

5 Marlborough Court
 Colney Road
 Cambridge
 CB3 9NA
 Tel: +44 (0)1223 210000
 Fax: +44 (0)1223 210000
 www.atkinsrealis.com

GREATER CAMBRIDGE PARTNERSHIP
 Growing and sharing prosperity
 Together we can do it.

Project Title
 WATER BEACH TO CAMBRIDGE
 PUBLIC TRANSPORT SCHEME

Drawing Title
 PROPOSED GENERAL ARRANGEMENT
 SHEET 3 OF 9

Project	Client	Contract	Revision
W2CPTS	ATK	HGM	XX
Revision	DR - CH	002003	

Sheet	Scale	Date	Author	Checker	Reviewed	Approved
A1	1:200	1-2020				

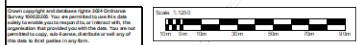

DO NOT SCALE

Metres

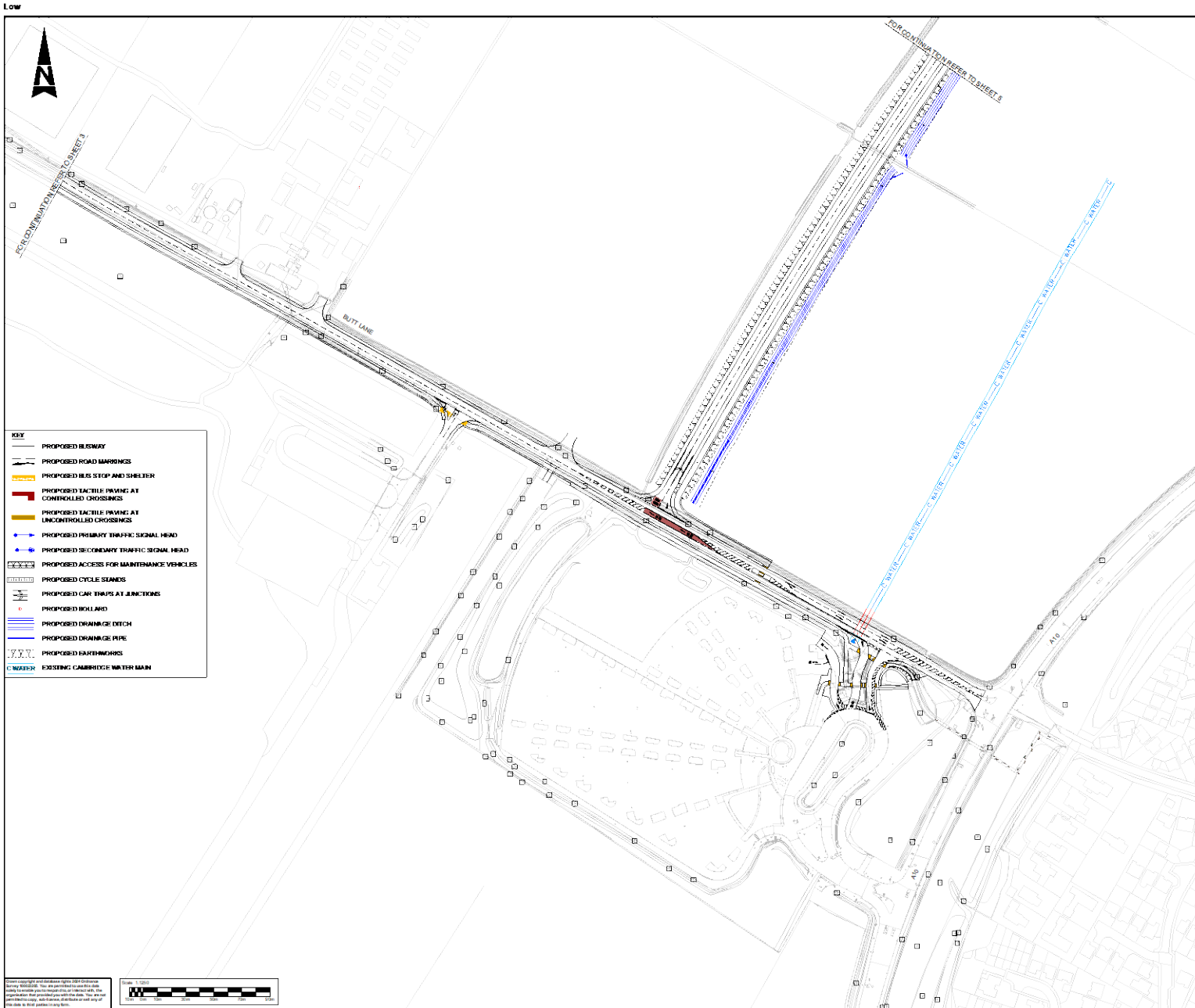

- KEY**
- PROPOSED BUSWAY
 - PROPOSED ROAD MARKINGS
 - PROPOSED BUS STOP AND SHELTER
 - PROPOSED TACTILE PAVING AT CONTROLLED CROSSINGS
 - PROPOSED TACTILE PAVING AT UNCONTROLLED CROSSINGS
 - ▶ PROPOSED PRIMARY TRAFFIC SIGNAL HEAD
 - ◀ PROPOSED SECONDARY TRAFFIC SIGNAL HEAD
 - PROPOSED ACCESS FOR MAINTENANCE VEHICLES
 - PROPOSED CYCLE STANDS
 - PROPOSED CAR THUS AT JUNCTIONS
 - PROPOSED BOLLARD
 - PROPOSED DRAINAGE DITCH
 - PROPOSED DRAINAGE PIPE
 - PROPOSED EARTHWORKS
 - EXISTING CAMBRIDGE WATER MAIN

- NOTE 3**
1. ALL DIMENSIONS ARE IN METRES UNLESS STATED OTHERWISE
 2. THIS DRAWING IS TO BE PRINTED IN COLOUR.
 3. SOME ITEMS DESCRIBED IN THE NOTES AND KEY MAY NOT APPLY TO THIS DRAWING.
 4. THE INFORMATION SHOWN ON THIS DRAWING IS INDICATIVE AND IS SUBJECT TO CHANGE PENDING FURTHER DESIGN DEVELOPMENT.
 5. THIS DRAWING HAS BEEN PREPARED BASED ON THE AERIAL TOPOGRAPHICAL SURVEY PROVIDED. LINE 2025 AND IS TO BE VALIDATED AGAINST THE GROUND TOPOGRAPHICAL SURVEY ONCE AVAILABLE.
 6. ENVIRONMENTAL MITIGATIONS NOT FINALISED AND THEREFORE NOT SHOWN.
 7. LIGHTING IS PROPOSED AT JUNCTIONS, TRAVEL HUB AND SENSITIVE LOCATIONS. LIGHTING DESIGN NOT FINALISED AND THEREFORE NOT SHOWN.
 8. DRAINAGE DESIGN INCOMPLETE. DITCHES TO BE FINALISED AND EXTENDED WHERE REQUIRED. HEADWALLS AND GUTTERALS TO BE DESIGNED.
 9. EXISTING UTILITIES PRESENT BUT NOT SHOWN EXCEPT THE CAMBRIDGE WATER MAIN. UTILITIES DIMENSIONS TO BE DESIGNED ONCE CESS ARE COMPLETED.
 10. TRAVEL HUB LAYOUT IS INDICATIVE AND SUBJECT TO CHANGE.
 11. UTILITIES AND INFRASTRUCTURE ON THE TRAVEL HUB, INCLUDING LIGHTING, SOLAR PANEL CANOPIES, BUILDING INFRASTRUCTURE, CONNECTIONS AND POWER SUPPLY, NOT DESIGNED AND NOT SHOWN.
 12. FLOOD COMPENSATION AREAS BEING DEVELOPED AND NOT SHOWN UNTIL VALIDATION WITH THE ENVIRONMENT AGENCY.

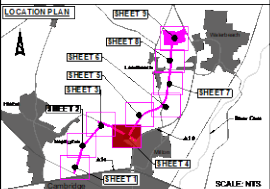

Authorisation						
Drawn	Checked	Design	Checked	Reviewed	Authorised	Issue Date
Design						
Drawn	Checked	Design	Checked	Reviewed	Authorised	Issue Date
Approval						
Drawn	Checked	Design	Checked	Reviewed	Authorised	Issue Date
Client						
Drawn	Checked	Design	Checked	Reviewed	Authorised	Issue Date

5 Marlborough Court
 Gifford Road
 Cambridge
 CB2 3DA
 Tel: +44 (0)1223 270000
 Fax: +44 (0)1223 270000
 www.atkinsrealis.com

Copyright © AtkinsRéalis (2024)

GREATER CAMBRIDGE PARTNERSHIP
 Growing and sharing prosperity
 for living our City best

Project Title
WATER BEACH TO CAMBRIDGE PUBLIC TRANSPORT SCHEME

Drawing Title
PROPOSED GENERAL ARRANGEMENT SHEET 4 OF 9

Drawing Number			
Project	Design	Revision	Issue
W2CPTS	ATK	HGM	
Location	XX	DR - CH	002004
Sheet	A1	Issue	1-2024
Project	Ref no. 0228204	Issue	4 of 9
Sheet		Issue	PD 12

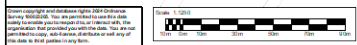

DC NOT SCALE

Metres

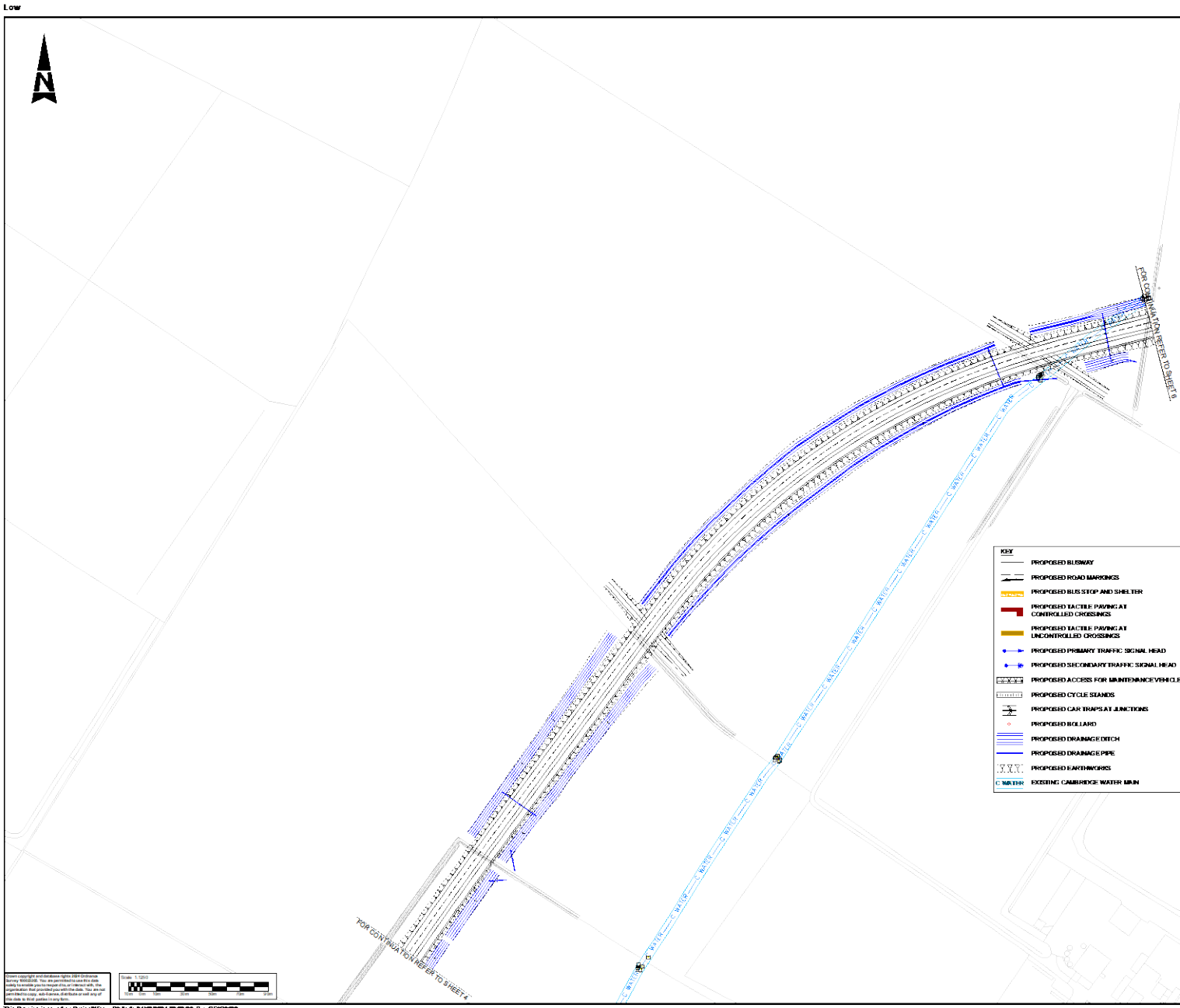

FOR CONTINUATION REFER TO SHEET 4

- NOTE 3**
1. ALL DIMENSIONS ARE IN METRES UNLESS STATED OTHERWISE
 2. THIS DRAWING IS TO BE PRINTED IN COLOUR.
 3. SOME ITEMS DESCRIBED IN THE NOTES AND KEY MAY NOT APPLY TO THIS DRAWING.
 4. THE INFORMATION SHOWN ON THIS DRAWING IS INDICATIVE AND IS SUBJECT TO CHANGE PENDING FURTHER DESIGN DEVELOPMENT.
 5. THIS DRAWING HAS BEEN PREPARED BASED ON THE AERIAL TOPOGRAPHICAL SURVEY PROVIDED AND IS INTENDED TO BE VALIDATED AGAINST THE GROUND TOPOGRAPHICAL SURVEY ONCE AVAILABLE.
 6. ENVIRONMENTAL MITIGATIONS NOT FINALISED AND THEREFORE NOT SHOWN
 7. LIGHTING IS PROPOSED AT JUNCTIONS, TRAVEL HUB AND SENSITIVE LOCATIONS. LIGHTING DESIGN NOT FINALISED AND THEREFORE NOT SHOWN
 8. DRAINAGE DESIGN INCOMPLETE. DITCHES TO BE FINALISED AND EXTENDED WHERE REQUIRED. HEADWALLS AND GUTTERALS TO BE DESIGNED
 9. EXISTING UTILITIES PRESERVE BLUE NOT SHOWN EXCEPT THE CAMBRIDGE WATER MAIN. UTILITIES DIMENSIONS TO BE DESIGNED ONCE CESS ARE COMPLETED
 10. TRAVEL HUB LAYOUT IS INDICATIVE AND SUBJECT TO CHANGE
 11. UTILITIES AND INFRASTRUCTURE ON THE TRAVEL HUB INCLUDING LIGHTING, SOLAR PANEL CANOPIES, BUILDING INFRASTRUCTURE, CONNECTIONS AND POWER SUPPLY, NOT DESIGNED AND NOT SHOWN
 12. FLOOD COMPENSATION AREAS BEING DEVELOPED AND NOT SHOWN UNTIL VALIDATION WITH THE ENVIRONMENT AGENCY

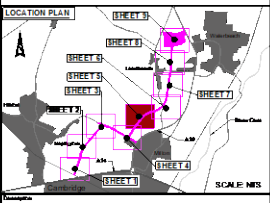

KEY

- PROPOSED BUSWAY
- PROPOSED ROAD MARGINS
- PROPOSED BUS STOP AND SHELTER
- PROPOSED TACTILE PAVING AT CONTROLLED CROSSINGS
- PROPOSED TACTILE PAVING AT UNCONTROLLED CROSSINGS
- PROPOSED PRIMARY TRAFFIC SIGNAL HEAD
- PROPOSED SECONDARY TRAFFIC SIGNAL HEAD
- PROPOSED ACCESS FOR MAINTENANCE VEHICLES
- PROPOSED CYCLE STAMPS
- PROPOSED CAR TRAPS AT JUNCTIONS
- PROPOSED BOLLARD
- PROPOSED DRAINAGE DITCH
- PROPOSED DRAINAGE PIPE
- PROPOSED EARTHWORKS
- EXISTING CAMBRIDGE WATER MAIN

Drawn	Checked	Design	Checked	Reviewed	Authorised	Issue Date

AtkinsRéalis

5 Malvern Court
Gordon Road
Cambridge
CB2 3BA
Tel: +44 (0)1223 270000
Fax: +44 (0)1223 270000
www.atkinsrealis.com

Copyright © AtkinsRéalis (2024)

GREATER CAMBRIDGE PARTNERSHIP

Growing and sharing prosperity
for living our City best

WATER BEACH TO CAMBRIDGE PUBLIC TRANSPORT SCHEME

PROPOSED GENERAL ARRANGEMENT SHEET 5 OF 9

Revision	Description	By	Date
WZCPTS - ATK - HGM			
XX - DR - CH			002005

Drawn	Issue	1-2020	Project	Ref no. 0228204	Scale	1:1000	Sheet	5 of 9
Sheet	A1							

Scale: 1:1000

The Drawing is based on Project WZCPTS - Phase 4 - 04/2024 - 08/22/26 by: CHC/GR/2

DO NOT SCALE

Low

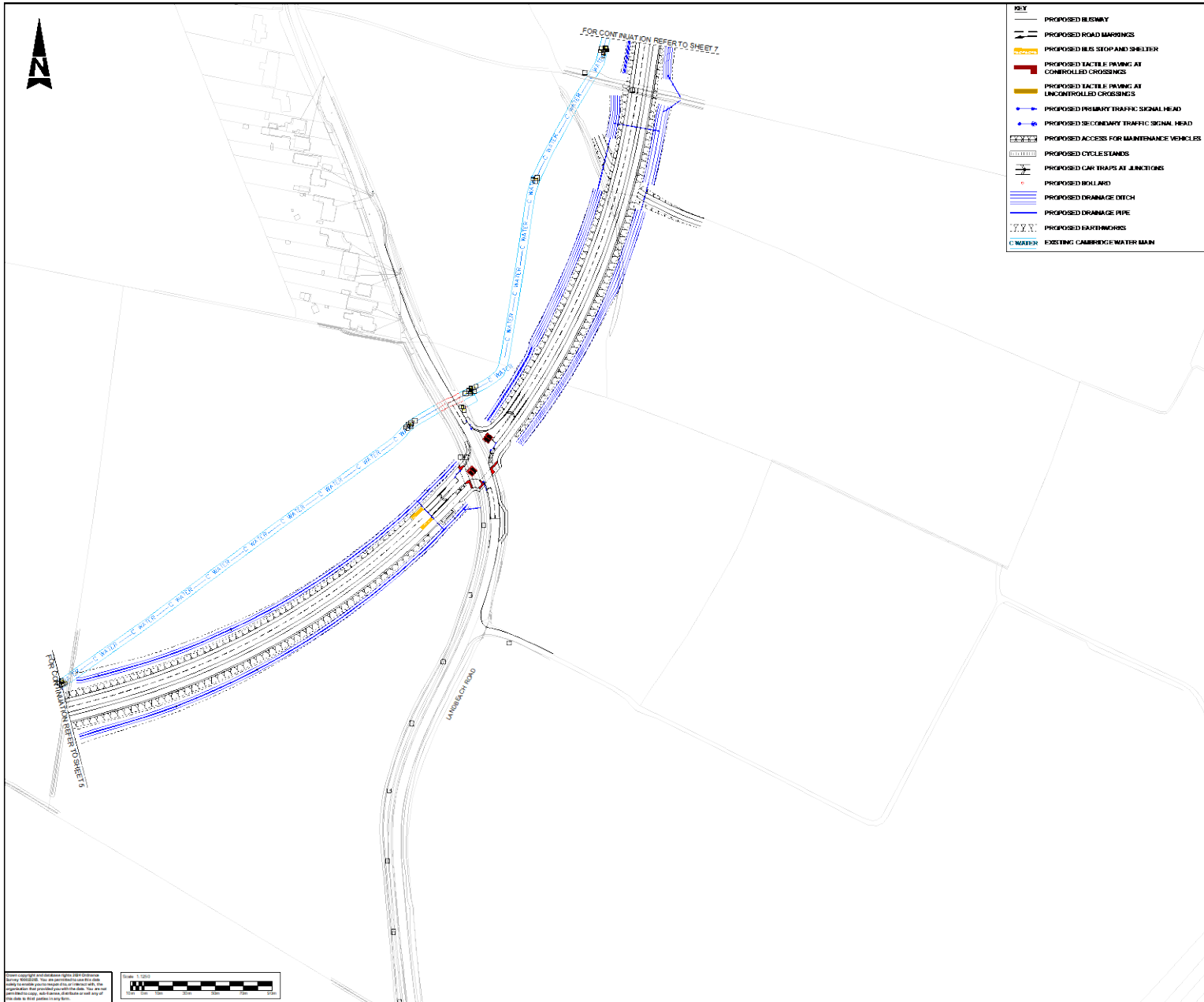

KEY

- PROPOSED ROAD MARGINS
- PROPOSED BUS STOP AND SHELTER
- PROPOSED CYCLE PATHS AT CONTROLLED CROSSINGS
- PROPOSED CYCLE PATHS AT UNCONTROLLED CROSSINGS
- PROPOSED PRIMARY TRAFFIC SIGNAL HEAD
- PROPOSED SECONDARY TRAFFIC SIGNAL HEAD
- PROPOSED ACCESS FOR MAINTENANCE VEHICLES
- PROPOSED CYCLE STANDS
- PROPOSED CAR TRAPS AT JUNCTIONS
- PROPOSED BOLLARD
- PROPOSED DRAINAGE DITCH
- PROPOSED DRAINAGE PIPE
- PROPOSED EARTHMOUNDS
- EXISTING CAMBRIDGE WATER MAIN

- NOTE 1**
1. ALL DIMENSIONS ARE IN METRES UNLESS STATED OTHERWISE
 2. THIS DRAWING IS TO BE PRINTED IN COLOUR.
 3. SOME ITEMS DESCRIBED IN THE NOTES AND KEY MAY NOT APPLY TO THIS DRAWING.
 4. THE INFORMATION SHOWN ON THIS DRAWING IS INDICATIVE AND IS SUBJECT TO CHANGE PENDING FURTHER DESIGN DEVELOPMENT.
 5. THIS DRAWING HAS BEEN PREPARED BASED ON THE AERIAL TOPOGRAPHICAL SURVEY PROVIDED. LINE ZONES ARE TO BE VALIDATED AGAINST THE GROUND TOPOGRAPHICAL SURVEY ONCE AVAILABLE.
 6. ENVIRONMENTAL MITIGATIONS NOT FINALISED AND THEREFORE NOT SHOWN.
 7. LIGHTING IS PROPOSED AT JUNCTIONS, TRAVEL HUB AND SENSITIVE LOCATIONS. LIGHTING DESIGN NOT FINALISED AND THEREFORE NOT SHOWN.
 8. DRAINAGE DESIGN INCOMPLETE. DITCHES TO BE FINALISED AND EXTENDED WHERE REQUIRED. HEADWALLS AND OUTFALLS TO BE DESIGNED.
 9. EXISTING UTILITIES PRESERVE BUT NOT SHOWN EXCEPT THE CAMBRIDGE WATER MAIN. UTILITIES DIMENSIONS TO BE DESIGNED ONCE CESS ARE COMPLETED.
 10. TRAVEL HUB LAYOUT IS INDICATIVE AND SUBJECT TO CHANGE.
 11. UTILITIES AND INFRASTRUCTURE ON THE TRAVEL HUB, INCLUDING LIGHTING, SOLAR PANEL CANOPIES, BUILDING INFRASTRUCTURE, CONNECTIONS AND POWER SUPPLY, NOT DESIGNED AND NOT SHOWN.
 12. FLOOD COMPENSATION AREAS BEING DEVELOPED AND NOT SHOWN UNTIL VALIDATION WITH THE ENVIRONMENT AGENCY.

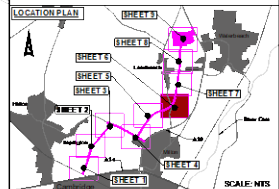

Author	Checker	Designer	Drawn	Reviewed	Authorised	Issue Date

FIRST ISSUE

Issue	Author	Checker	Designer	Drawn	Reviewed	Authorised	Issue Date
01							

Drawing Number: **PD12**

5 Mallik Court
Gatineau Road
Cambridge
Cambridgeshire
CB3 0NA
Tel: +44 (0)1223 276000
Fax: +44 (0)1223 276200
www.atkinsrealis.com

Copyright © AtkinsRéalis (2024)

GREATER CAMBRIDGE PARTNERSHIP
Growing and sharing prosperity
Soaring our City Deal

PROJECT TITLE
WATERBEACH TO CAMBRIDGE
PUBLIC TRANSPORT SCHEME

DRAWING TITLE
PROPOSED GENERAL ARRANGEMENT
SHEET 6 OF 9

Author	Checker	Designer	Drawn	Reviewed	Authorised	Issue Date

Project W2CPTS - ATK - HCM
Sheet XX - DR - CH - 002006

Revision	Author	Date	Description
1			

Sheet: **A1** Issue: **1-2024** Project: **W2CPTS** Issue: **6 of 9** Sheet: **PD12**

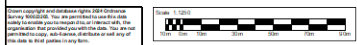

This Drawing is based on Project/Phase: **Phase 4: 04/10/2024 09:28:45** by: **CR03/02**

DO NOT SCALE

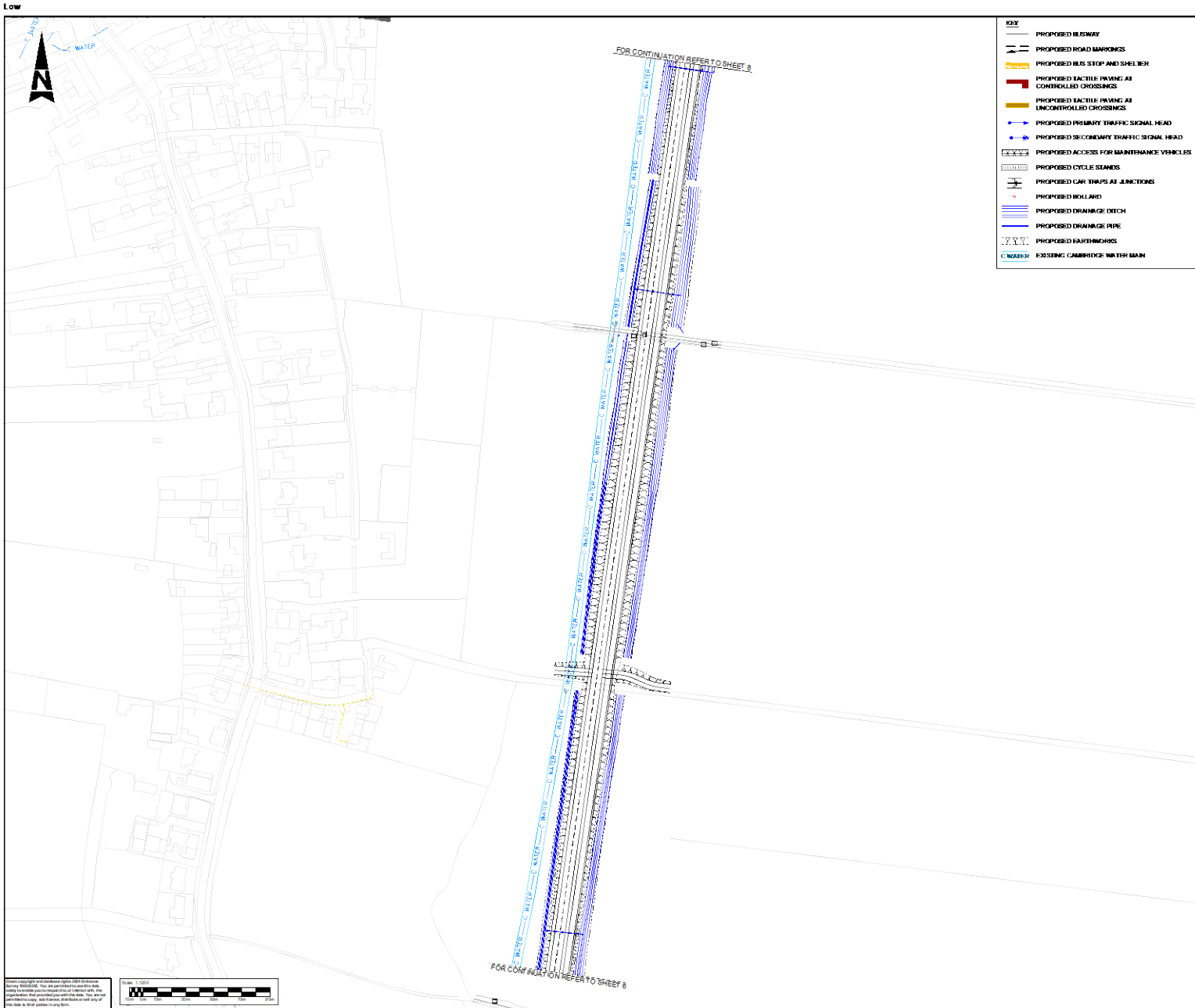

- KEY**
- PROPOSED BUSWAY
 - PROPOSED ROAD MARKINGS
 - PROPOSED BUS STOP AND SHELTER
 - PROPOSED TACTILE PAVING AT CONTROLLED CROSSINGS
 - PROPOSED TACTILE PAVING AT UNCONTROLLED CROSSINGS
 - PROPOSED PRIMARY TRAFFIC SIGNAL HEAD
 - PROPOSED SECONDARY TRAFFIC SIGNAL HEAD
 - PROPOSED ACCESS FOR MAINTENANCE VEHICLES
 - PROPOSED CYCLE ISLANDS
 - PROPOSED CAR TRAPS AT JUNCTIONS
 - PROPOSED BOLLARD
 - PROPOSED DRAINAGE DITCH
 - PROPOSED DRAINAGE PIPE
 - PROPOSED EARTHWORKS
 - EXISTING CAMBRIDGE WATER MAIN

- NOTE 1**
1. ALL DIMENSIONS ARE IN METRES UNLESS STATED OTHERWISE
 2. THIS DRAWING IS TO BE PRINTED IN COLOUR.
 3. SOME ITEMS DESCRIBED IN THE NOTES AND KEY MAY NOT APPLY TO THIS DRAWING.
 4. THE INFORMATION SHOWN ON THIS DRAWING IS INDICATIVE AND IS SUBJECT TO CHANGE PENDING FURTHER DESIGN DEVELOPMENT.
 5. THIS DRAWING HAS BEEN PREPARED BASED ON THE AERIAL TOPOGRAPHICAL SURVEY PROVIDED. THIS SHOULD BE VALIDATED AGAINST THE GROUND TOPOGRAPHICAL SURVEY ONCE AVAILABLE.
 6. ENVIRONMENTAL MITIGATIONS NOT FINALISED AND THEREFORE NOT SHOWN.
 7. LIGHTING IS PROPOSED AT JUNCTIONS, TRAVEL HUBS AND SENSITIVE LOCATIONS. LIGHTING DESIGN NOT FINALISED AND THEREFORE NOT SHOWN.
 8. DRAINAGE DESIGN INCOMPLETE. DITCHES TO BE FINALISED AND EXTENDED WHERE REQUIRED. HEADWALLS AND GUTTERS TO BE DESIGNED.
 9. EXISTING UTILITIES PRESENT BUT NOT SHOWN EXCEPT THE CAMBRIDGE WATER MAIN. UTILITIES DIMENSIONS TO BE DESIGNED ONCE CSS ARE COMPLETED.
 10. TRAVEL HUB LAYOUT IS INDICATIVE AND SUBJECT TO CHANGE.
 11. UTILITIES AND INFRASTRUCTURE ON THE TRAVEL HUB, INCLUDING LIGHTING, SOLAR PANEL CANOPIES, BUILDING INFRASTRUCTURE, CONNECTIONS AND POWER SUPPLY, NOT DESIGNED AND NOT SHOWN.
 12. FLOOD COMPENSATION AREAS BEING DEVELOPED AND NOT SHOWN UNTIL VALIDATION WITH THE ENVIRONMENT AGENCY.

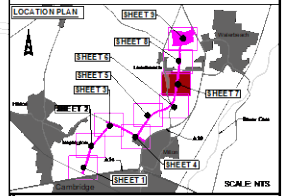

Revision	Number	Reason	Checked	Reviewed	Authorised	Issue Date

DESIGNER'S FIRST ISSUE:

Revision	Number	Reason	Checked	Reviewed	Authorised	Issue Date

Drawing Details:

--	--	--	--	--

AtkinsRéalis

3 Mallwood Court
Gordon Road
Cambridge
Cambridgeshire
CB3 0NA
Tel: +44 (0)1223 216000
Fax: +44 (0)1223 216200
www.atkinsrealis.com

Copyright © AtkinsRéalis (2024)

GREATER CAMBRIDGE PARTNERSHIP
Growing and sharing prosperity
Let's make our City Deal

Project Title
WATERBEACH TO CAMBRIDGE
PUBLIC TRANSPORT SCHEME

Drawing Title
PROPOSED GENERAL ARRANGEMENT
SHEET 7 OF 9

Client	Project	Package	Volume	Sheet
WZCPTS	ATK	HGM	XX	- DR - CH - 002007

Revision:

--	--	--	--	--

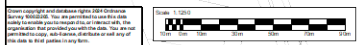

DO NOT SCALE

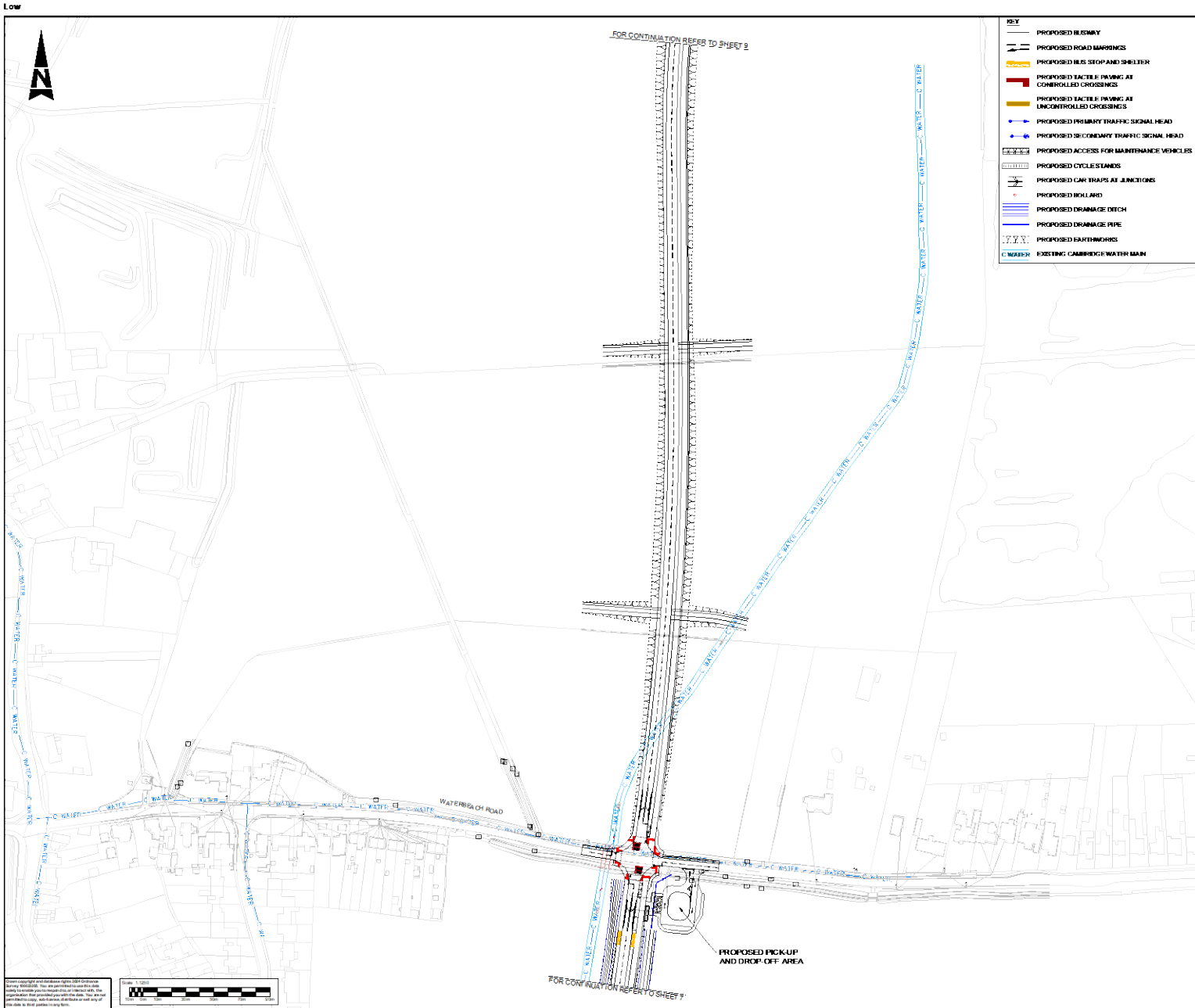

KEY

- PROPOSED BUSWAY
- PROPOSED ROAD MARGINS
- PROPOSED BUS STOP AND SHELTER
- PROPOSED FACILE PAVING AT CONTROLLED CROSSINGS
- PROPOSED FACILE PAVING AT UNCONTROLLED CROSSINGS
- PROPOSED PRIMARY TRAFFIC SIGNAL HEAD
- PROPOSED SECONDARY TRAFFIC SIGNAL HEAD
- PROPOSED ACCESS FOR MAINTENANCE VEHICLES
- PROPOSED CYCLE STANDS
- PROPOSED CAR TRAPS AT JUNCTIONS
- PROPOSED HOLLAND
- PROPOSED DRAINAGE DITCH
- PROPOSED DRAINAGE PIPE
- PROPOSED BARRIERS
- EXISTING CAMBRIDGE WATER MAIN

- NOTE 3**
1. ALL DIMENSIONS ARE IN METRES UNLESS STATED OTHERWISE
 2. THIS DRAWING IS TO BE PRINTED IN COLOUR.
 3. SOME ITEMS DESCRIBED IN THE NOTES AND KEY MAY NOT APPLY TO THIS DRAWING.
 4. THE INFORMATION SHOWN ON THIS DRAWING IS INDICATIVE AND IS SUBJECT TO CHANGE PENDING FURTHER DESIGN DEVELOPMENT.
 5. THIS DRAWING HAS BEEN PREPARED BASED ON THE AERIAL TOPOGRAPHICAL SURVEY PROVIDED. LINE ZONE DATA TO BE VALIDATED AGAINST THE GROUND TOPOGRAPHICAL SURVEY ONCE AVAILABLE.
 6. ENVIRONMENTAL MITIGATIONS NOT FINALISED AND THEREFORE NOT SHOWN.
 7. LIGHTING IS PROPOSED AT JUNCTIONS, TRAVEL HUBS AND SENSITIVE LOCATIONS. LIGHTING DESIGN NOT FINALISED AND THEREFORE NOT SHOWN.
 8. DRAINAGE DESIGN INCOMPLETE. DITCHES TO BE FINALISED AND EXTENDED WHERE REQUIRED. HEADWALLS AND GUTTERS TO BE DESIGNED.
 9. EXISTING UTILITIES PRESENT BUT NOT SHOWN EXCEPT THE CAMBRIDGE WATER MAIN. UTILITIES DIMENSIONS TO BE DESIGNED ONCE CSS ARE COMPLETED.
 10. TRAVEL HUB LAYOUT IS INDICATIVE AND SUBJECT TO CHANGE.
 11. UTILITIES AND INFRASTRUCTURE ON THE TRAVEL HUB, INCLUDING LIGHTING, SOLAR PANEL CANOPIES, BUILDING INFRASTRUCTURE, CONNECTIONS AND POWER SUPPLY, NOT DESIGNED AND NOT SHOWN.
 12. FLOOD COMPENSATION AREAS BEING DEVELOPED AND NOT SHOWN UNTIL VALIDATION WITH THE ENVIRONMENT AGENCY.

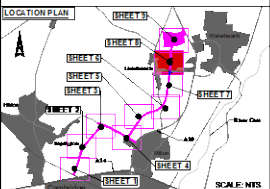

Discipline	Name	Role	Checked	Reviewed	Authorised	Issue Date
Author						
Designer						
Checker						
Authoriser						
Issue Date						

DISCIPLINE: PROJECT 2

Discipline	Name	Role	Checked	Reviewed	Authorised	Issue Date
Author						
Designer						
Checker						
Authoriser						
Issue Date						

AtkinsRéalis

Copyright © AtkinsRéalis (2024)

3 Mallik Road Court
Gatineau Road
Cambridge
Ontario
N3H 5D4
Tel: +44 (0)1223 270000
Fax: +44 (0)1223 270000
www.atkinsrealis.com

GREATER CAMBRIDGE PARTNERSHIP

Growing and sharing prosperity
Let's bring our City best

PROJECT TITLE: WATERBEACH TO CAMBRIDGE PUBLIC TRANSPORT SCHEME

DRAWING TITLE: PROPOSED GENERAL ARRANGEMENT SHEET 8 OF 9

Project	W2CPTS	Client	ATK	Contract	HCW
Revision	ZZ	Discipline	DR	Code	CH
Sheet	A1	Issue	1-2024	Project No.	0228204
Scale	1:1000	Issue	8 of 8	Sheet	PD 12

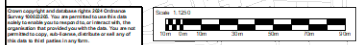

DO NOT SCALE

METERS

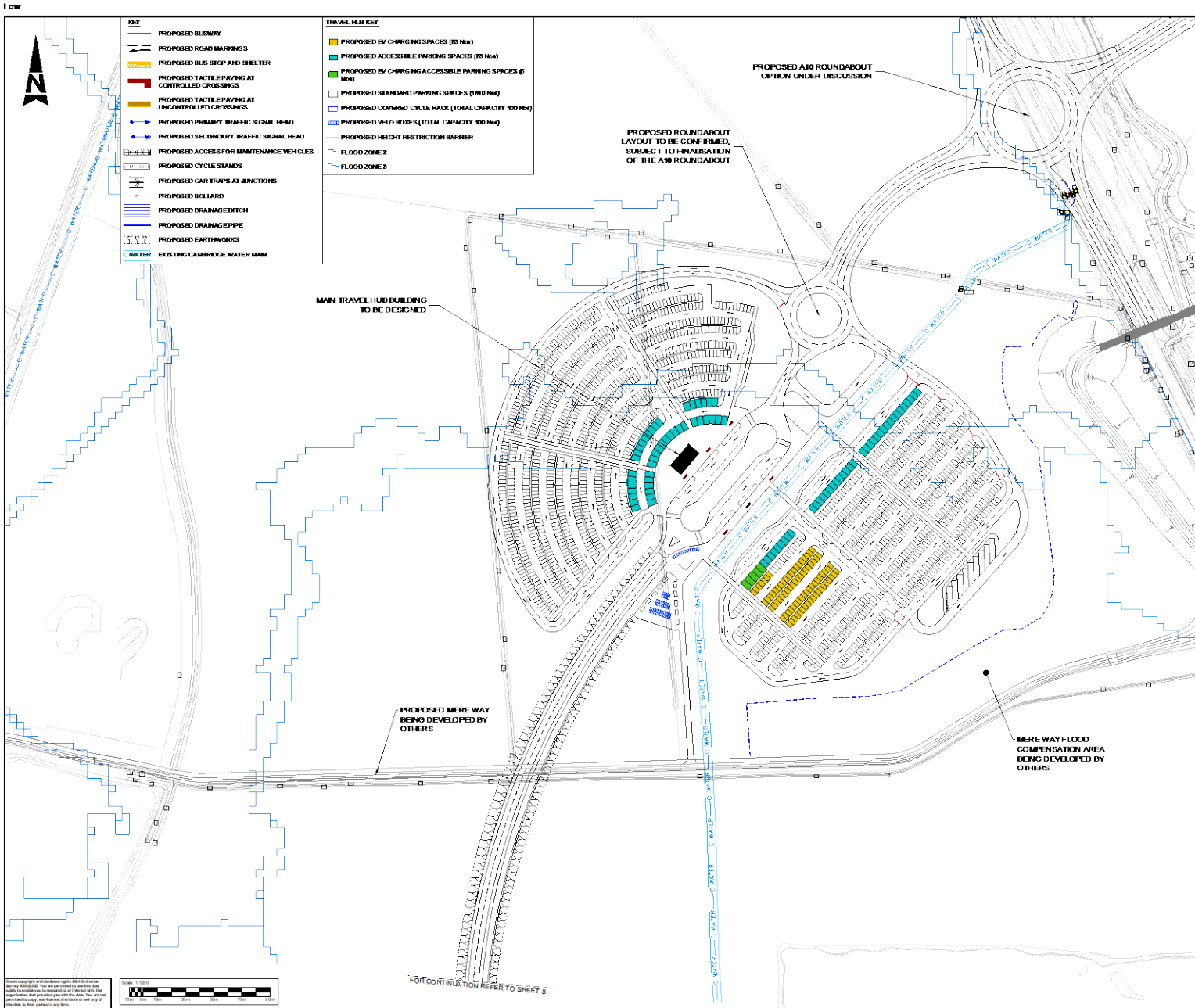

- KEY**
- PROPOSED BUSWAY
 - PROPOSED ROAD MARKINGS
 - PROPOSED BUS STOP AND SHELTER
 - PROPOSED TACTILE PAVING AT CONTROLLED CROSSINGS
 - PROPOSED TACTILE PAVING AT UNCONTROLLED CROSSINGS
 - PROPOSED PRIMARY TRAFFIC SIGNAL HEAD
 - PROPOSED SECONDARY TRAFFIC SIGNAL HEAD
 - PROPOSED ACCESS FOR MAINTENANCE VEHICLES
 - PROPOSED CYCLE STANDS
 - PROPOSED CAR TRAPS AT JUNCTIONS
 - PROPOSED BOLLARD
 - PROPOSED DRAINAGE DITCH
 - PROPOSED DRAINAGE PIPE
 - PROPOSED EARTHWORKS
 - EXISTING CAMBRIDGE WATER MAIN

- TRAVEL HUB KEY**
- PROPOSED EV CHARGING SPACES (85 New)
 - PROPOSED ACCESSIBLE PARKING SPACES (85 New)
 - PROPOSED EV CHARGING ACCESSIBLE PARKING SPACES (8 New)
 - PROPOSED STANDARD PARKING SPACES (1100 New)
 - PROPOSED COVERED CYCLE RACK (TOTAL CAPACITY 100 New)
 - PROPOSED VELO BOXES (TOTAL CAPACITY 100 New)
 - PROPOSED HEIGHT RESTRICTION BARRIER
 - FLOOD ZONE 1
 - FLOOD ZONE 2
 - FLOOD ZONE 3

- NOTES**
1. ALL DIMENSIONS ARE IN METRES UNLESS STATED OTHERWISE
 2. THIS DRAWING IS TO BE PRINTED IN COLOUR.
 3. SOME ITEMS DESCRIBED IN THE NOTES AND KEY MAY NOT APPLY TO THIS DRAWING.
 4. THE INFORMATION SHOWN ON THIS DRAWING IS INDICATIVE AND SUBJECT TO CHANGE PENDING FURTHER DESIGN DEVELOPMENT.
 5. THIS DRAWING HAS BEEN PREPARED BASED ON THE AERIAL TOPOGRAPHICAL SURVEY PROVIDED JUNE 2020 AND IS TO BE VALIDATED AGAINST THE GROUND TOPOGRAPHICAL SURVEY ONCE AVAILABLE.
 6. ENVIRONMENTAL MITIGATIONS NOT FINALISED AND THEREFORE NOT SHOWN.
 7. LIGHTING IS PROPOSED AT JUNCTIONS, TRAVEL HUB AND SENSITIVE LOCATIONS. LIGHTING DESIGN NOT FINALISED AND THEREFORE NOT SHOWN.
 8. DRAINAGE DESIGN INCLUDING DETICHS TO BE FINALISED AND EXTENDED WHERE REQUIRED. HEADWALLS AND GUTTERALS TO BE DESIGNED.
 9. EXISTING UTILITIES PRESERVE BUT NOT SHOWN EXCEPT THE CAMBRIDGE WATER MAIN. UTILITIES DIVERSIONS TO BE DESIGNED ONCE CSES ARE COMPLETED.
 10. TRAVEL HUB LAYOUT IS INDICATIVE AND SUBJECT TO CHANGE.
 11. UTILITIES AND INFRASTRUCTURE ON THE TRAVEL HUB, INCLUDING LIGHTING, SOLAR PANELS, CANOPIES, BUILDING INFRASTRUCTURE, CONNECTIONS AND POWER SUPPLY, NOT DESIGNED AND NOT SHOWN.
 12. FLOOD COMPENSATION AREAS BEING DEVELOPED AND NOT SHOWN UNTIL VALIDATION WITH THE ENVIRONMENT AGENCY.

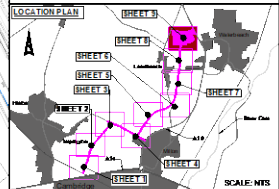

Sheet	Author	Drawn	Checked	Reviewed	Authorised	Issue Date
11						
12						
13						
14						
15						
16						
17						
18						
19						
20						
21						
22						
23						
24						
25						
26						
27						
28						
29						
30						
31						
32						
33						
34						
35						
36						
37						
38						
39						
40						
41						
42						
43						
44						
45						
46						
47						
48						
49						
50						
51						
52						
53						
54						
55						
56						
57						
58						
59						
60						
61						
62						
63						
64						
65						
66						
67						
68						
69						
70						
71						
72						
73						
74						
75						
76						
77						
78						
79						
80						
81						
82						
83						
84						
85						
86						
87						
88						
89						
90						
91						
92						
93						
94						
95						
96						
97						
98						
99						
100						

AtkinsRéalis

15 Marlborough Court
 Colney Road
 Cambridge
 Cambridgeshire
 CB3 0NA
 Tel: +44 (0)1223 270000
 Fax: +44 (0)1223 270000
 www.atkinsrealis.com

Copyright © AtkinsRéalis (2024)

GREATER CAMBRIDGE PARTNERSHIP
 Growing and sharing prosperity
 Together we can do it!

WATER BEACH TO CAMBRIDGE PUBLIC TRANSPORT SCHEME

PROPOSED GENERAL ARRANGEMENT SHEET 9 OF 9

Project	W2CPTS	Client	ATK	Drawn	HGM
Revision	XX	Checked	DR	Issue	CH 002009
Sheet	A1	Scale	1:1000	Project No.	6228204
Drawn		Date	04/01	Issue	01/12

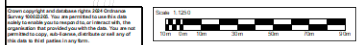

Questions?

Waterbeach station

Paul McGuigan

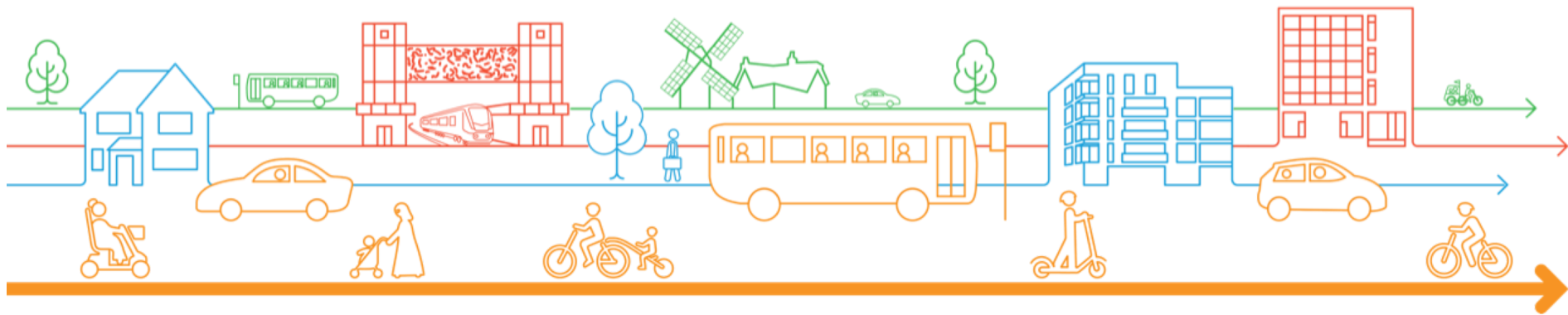

Scope of works – rail

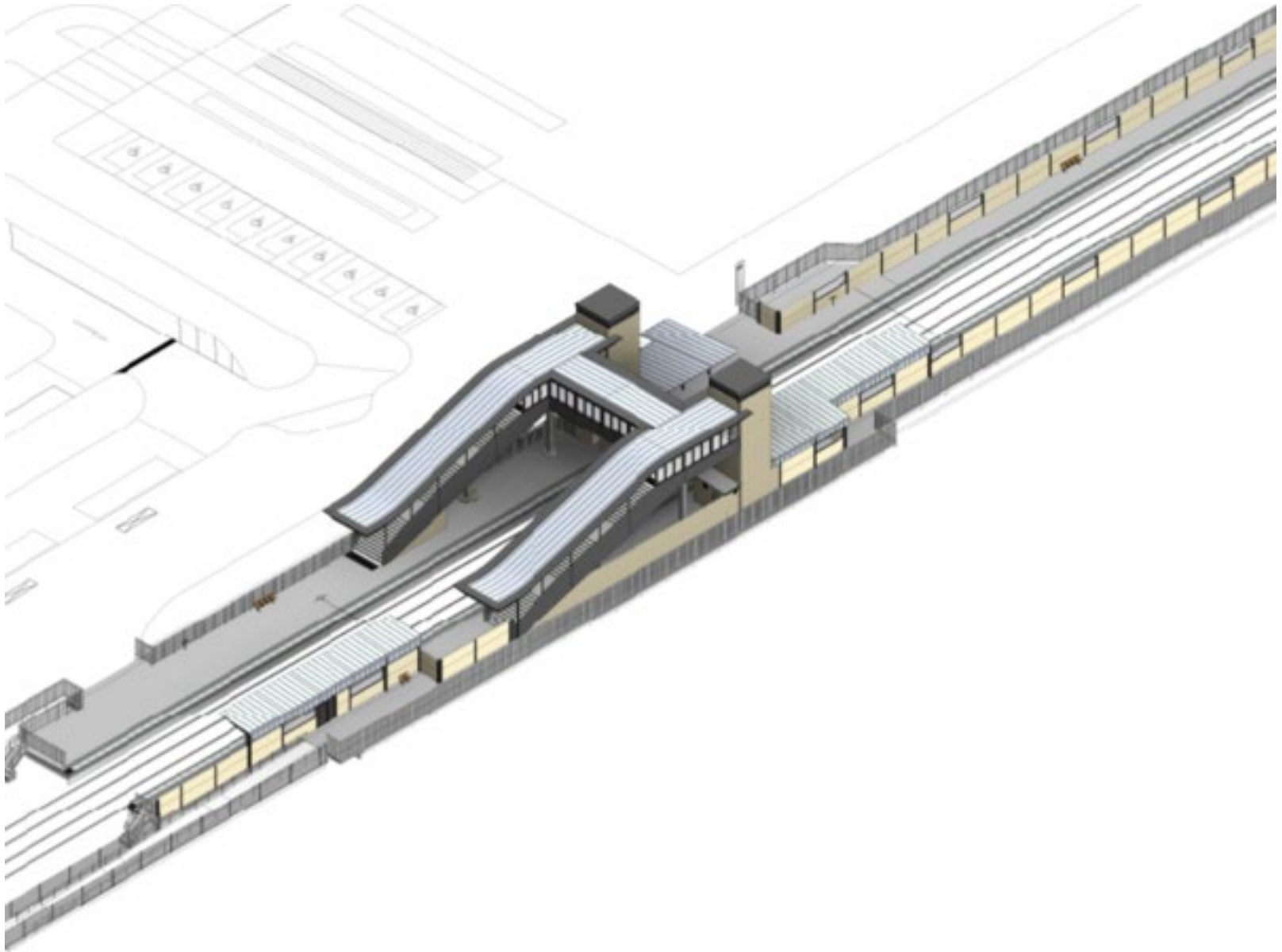

Scope of works – non-rail

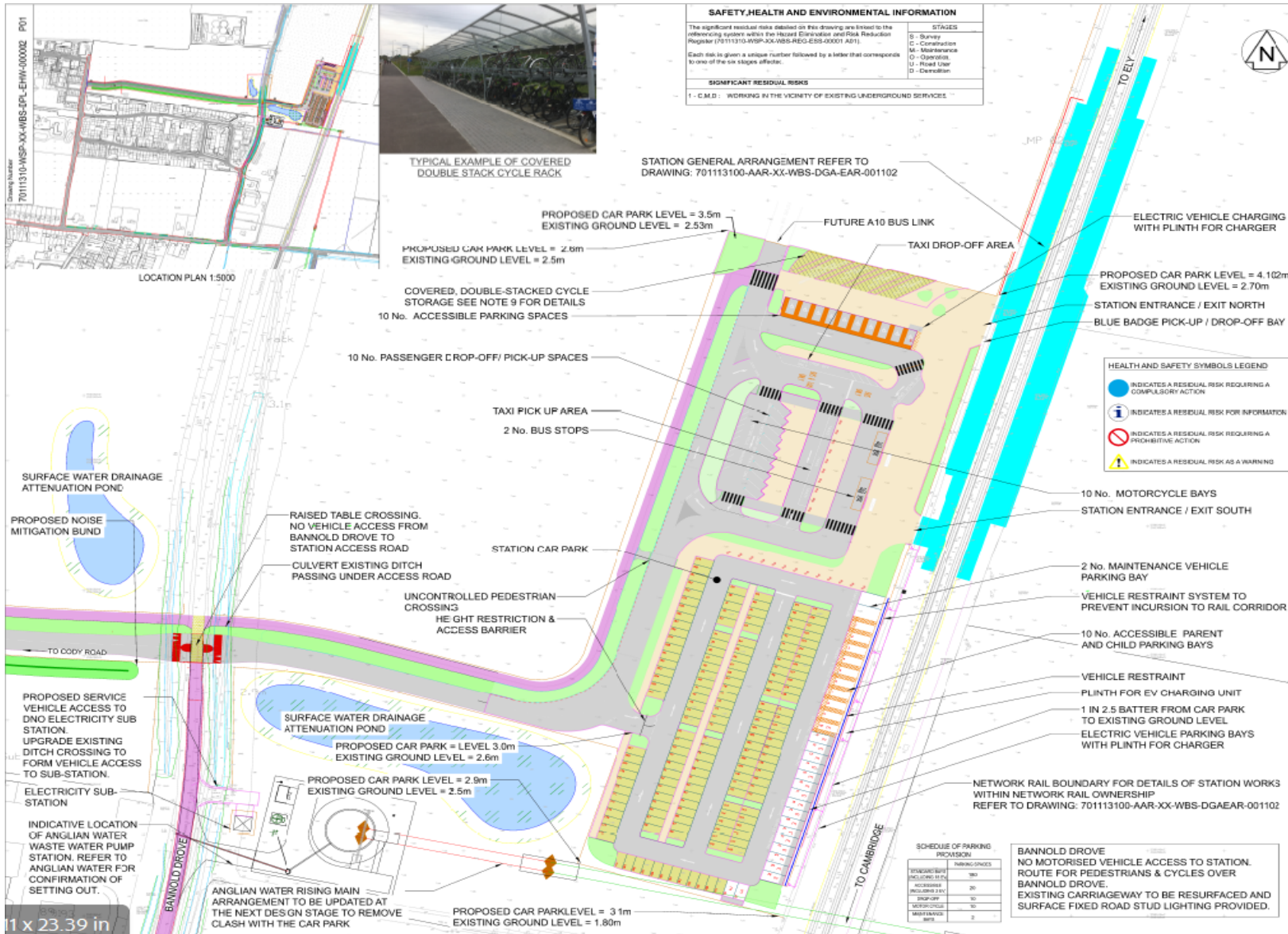

Current status

- Site surveys complete
- Preliminary design complete
- Design assurance (Network Rail and Cambridgeshire County Council)
- Main contractor procurement – pre-qualification & preparation of invitation to tender
- Station closure appraisal and engagement with Network Rail and DfT

Delivery programme

- Detailed design and D&B contract start – Mid 2025
- Detailed design end – winter 2026
- Haul road construction – summer 2025-winter 2026
- Station construction start – 2026
- Station construction end – 2027

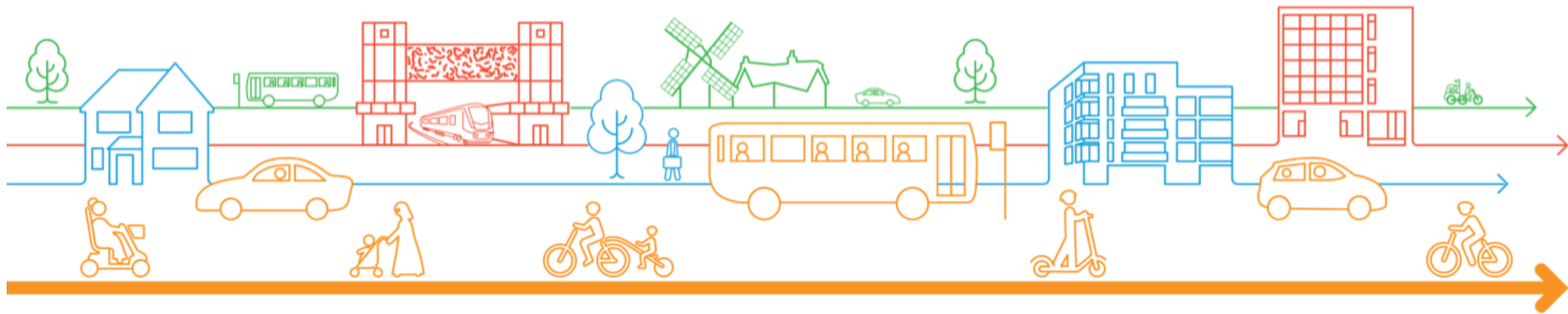

The construction haul road

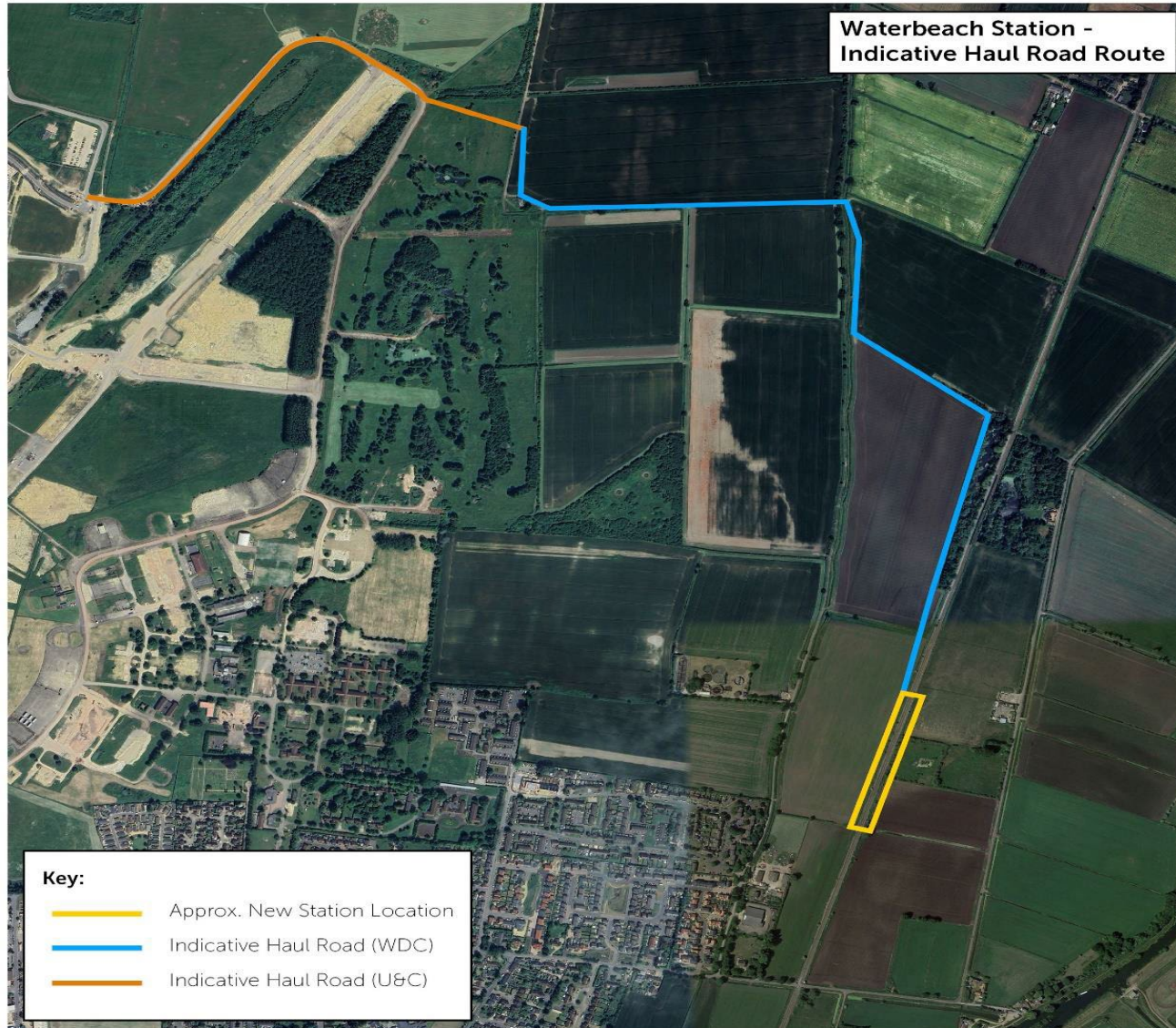

Station closure



Questions?